

i-LUMINOSITY
LED LIGHTING FIXTURES

Date: _____
Project: _____
Price: _____

Trigger LED Mini Wall Pack

DESCRIPTION

- . The Lampcover is injection-molded, one-piece, UV-stabilized PC and IP66 waterproof.
- . The function switches are on the side part of product, with a waterproof clear cover which can be screwed off easily.
- . Adjustable wattage 5W-20W-25W and Color temperature 3000K-4000K-5000K
- . Turning on or off photocell sensor, protected under the same clear cover
- . Default photocell, can be switched on or off.
- . The built-in power supply has a reserved port for 0-10V dimming function.



TECHNICAL SPECIFICATION

WATTAGE	15W/20W/25W(Adjustable)
LUMENS	1800-2400-3000Lm
DIMMING FUNCTION	0-10V dimming
VOLTAGE	AC120-277V
POWER FREQUENCY	>0.9
POWER FACTOR	60Hz
CCT	3000K-4000K-5000K CCT Tunable
CRI	80
LIFESPAN	≥50,000hours
MATERIAL	Aluminum+PC
FINISH	Bronze
OPERATING TEMP	-40°F to 122°F (-40°C to 50°C)
ENVIRONMENT	IP66
WARRANTY	5 year limited



FEATURES:

- Die Cast Aluminum housing with corrosion resistant polyester paint finish.
- UV stabilized PC lens providing resistance to corrosion and weathering.
- Photocell can be enabled or disabled to user preference.

DIMENSIONS

8.78" x 5.92" x 2.56"
(223 x 150.5 x 65 mm)

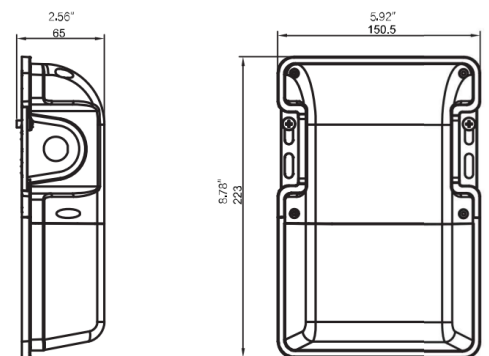

Date: _____
 Project: _____
 Price: _____

SETTING FUNCTION SWITCH

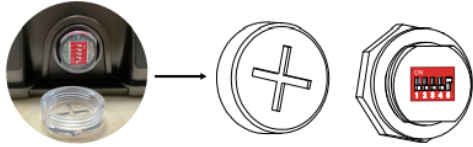

Wattage:



Photocell:



CCT:



INSTALLATION INSTRUCTION

loosen the four screws shown in diagram below

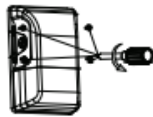

Fix the bottom plate to the round plate

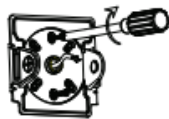

Remove the 1/2 end cap

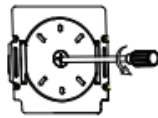

If you do not wish to use the photocell,unplug connector located at the top of fixture housing.



Peel off the yellow sticker and apply it to the round area of the bottom plate.

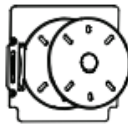

Replace bottom plate tighten the four screw

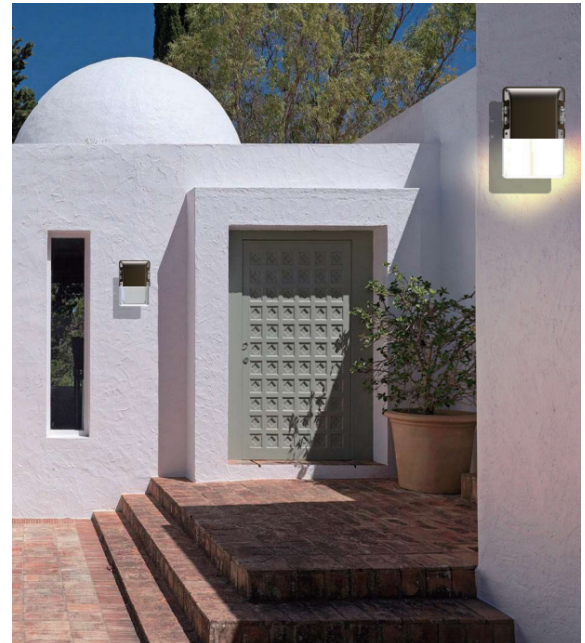
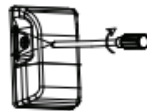

Ordering Key

ILWPTGMO

SERIES NUMBER	WATTAGE / LUMENS	CCT	FINISH	ADDITIONAL OPTIONS
ILWPTGMO	WT - 15W-20W-25W Selectable	CCT-3000K-4000K-5000K	DB - BARK BRONZE	PH - PHOTOCELL DM - 0-10V Dimmable

SAMPLE ITEM NUMBER: ILWPTGMO WT CCT DB PH DM

