

LED NEON LIGHT

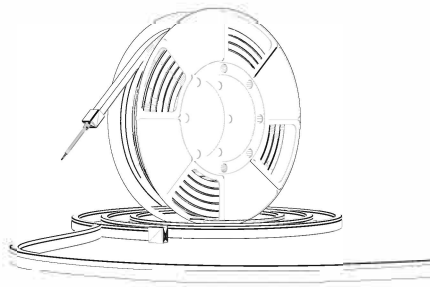

USER MANUAL

Note:

1. Read manuals attentively before installation.
2. Install by qualified electrician, be aware of antistatic factors.
3. Do not electrify it while installation is ongoing.
4. Cut off electricity while installing or removing.
5. Operating temperature: -20°C ~ +45°C.
6. Application space is with no chemical compositions such as sulphur, acid, halogen etc.

TOP BEND - NON-SOLDER

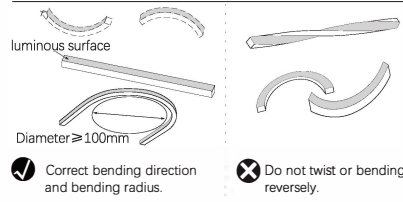

1. Cut it as per cutting symbol by special scissors.

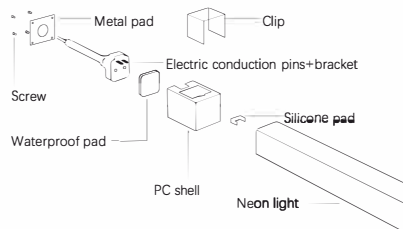
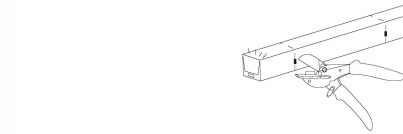

2. Installation steps for cable side

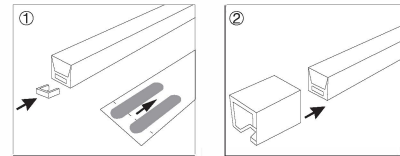

Insert silicone pad above on FPC to fix FPC.

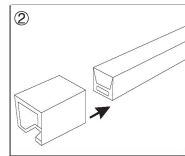

Put PC shell onto neon light (open side is at the back of neon light).

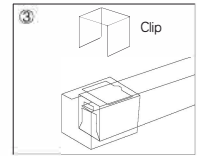

Insert clip into PC shell to fix neon light.

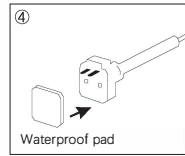

Fix waterproof pad on electric conduction pins.

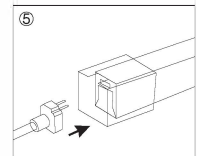

Insert electric conduction pins into end cap (make sure pins conduct to solder pads).

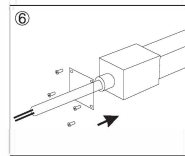

Fix metal pad onto PC shell by screws.

2.1. Installation steps for non-cable side

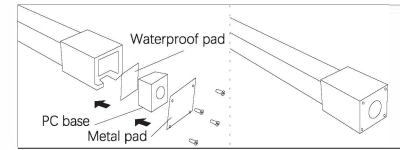

Repeat above steps ② and ③ to fix end cap at the tail, then fix waterproof pad, PC base and metal pad by screws as per diagram.

3. Installation steps

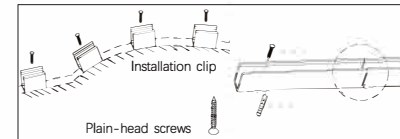

Install by clips or alu profile: fix installation clips or profile by screws, 2~3pcs of clip per meter (Note: put clip-clip or profile-profile at a line, do not use hump-head screw).

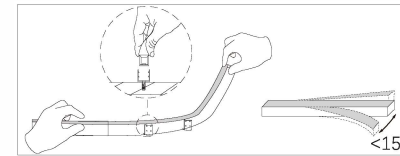

Press neon light into installation clips or profile, could do up and down bend, the angle of right and left bend should not be higher than 15°.

TOP BEND-SOLDER

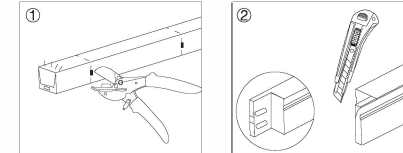

1. Cut it as per cutting symbol by special scissors.

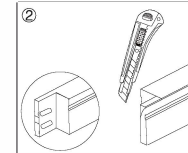

Cut little bit to show solder pads.

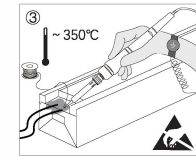

Wear electrostatic ring, solder around 3~5 seconds, temperature is no more than 350°C.

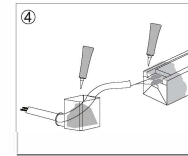

Cable through hole on end cap, fill silicone glue to occupy around 1/3 space.

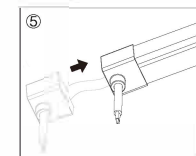

Insert end cap onto neon light, leave it to rest 2 hours to remove it.

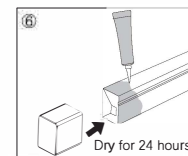

Spread silicone glue on the tail of neon light and then insert non-hole end cap. Dry for 24 hours.

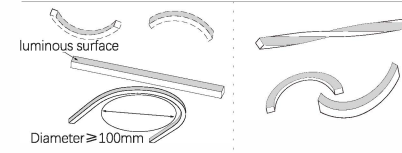

Correct bending direction and bending radius. Do not twist or bending reversely.

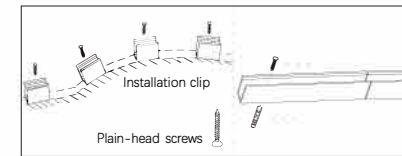

Install by clips or alu profile: fix installation clips or profile by screws, 2~3pcs of clip per meter (Note: put clip-clip or profile-profile at a line, do not use hump-head screw).

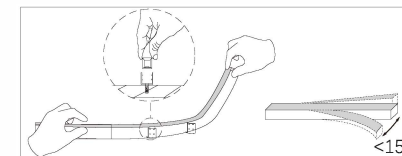

Press neon light into installation clips or profile, could do up and down bend, the angle of right and left bend should not be higher than 15°.

SIDE BEND-NON-SOLDER

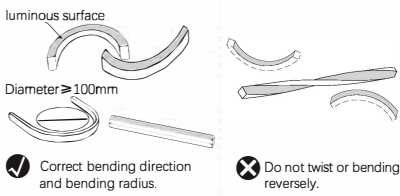

1. Cut it as per cutting symbol by special scissors.

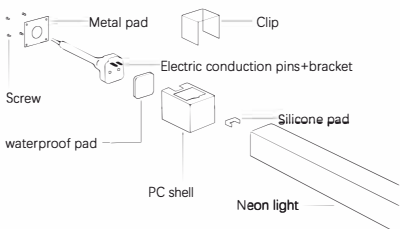
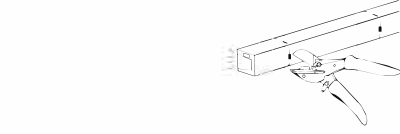

2. Installation steps for cable side

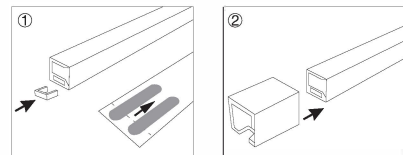

Insert silicone pad above on FPC to fix FPC.

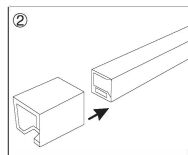

Put PC shell onto neon light (open side is at the back of neon light).

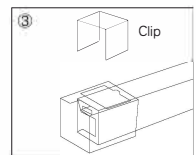

Insert clip into PC shell to fix neon light.

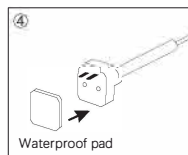

Fix waterproof pad on electric conduction pins.

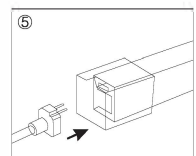

Insert electric conduction pins into end cap (make sure pins conduct to solder pads).

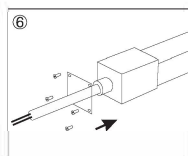

Fix metal pad onto PC shell by screws.

2.1. Installation steps for non-cable side

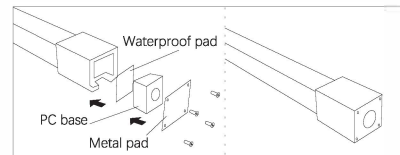

Repeat above steps ② and ③ to fix end cap at tail, then fix waterproof pad, PC base and metal pad by screws as per diagram.

3. Installation steps

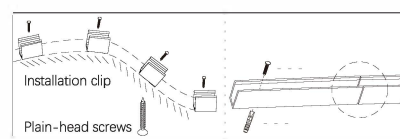

Install by clips or alu profile: fix installation clips or profile by screws, 2~3 pcs of clip per meter (Note: put clip-clip or profile-profile at a line, do not use hump-head screw).

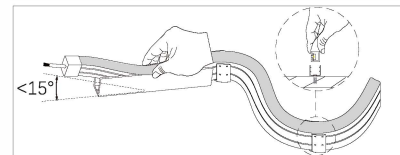

Press neon light into installation clips or profile, could do right and left bend, the angle of up and down bend should not be higher than 15°.

SIDE BEND-SOLDER

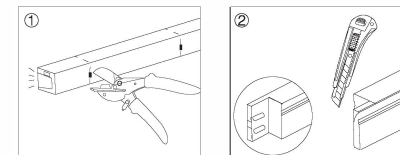

1. Cut it as per cutting symbol by special scissors.

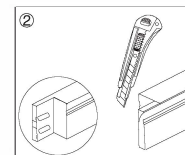

Cut little bit to show solder pads.

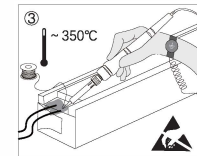

Wear electrostatic ring, solder around 3~5 seconds, temperature is no more than 350°C.

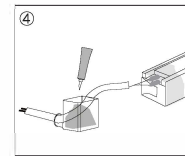

Cable through hole on end cap, fill silicone glue to occupy around 1/3 space.

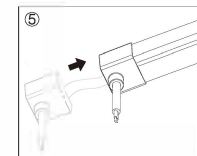

Insert end cap onto neon light, leave it to rest 2 hours to remove it.

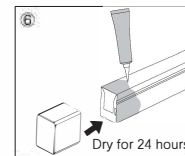

Spread silicone glue on the tail of neon light and then insert non-hole end cap. Dry for 24 hours.

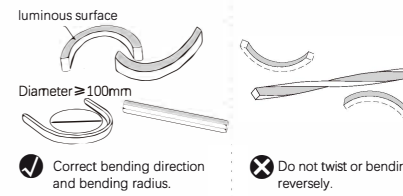

Correct bending direction and bending radius. Do not twist or bending reversely.

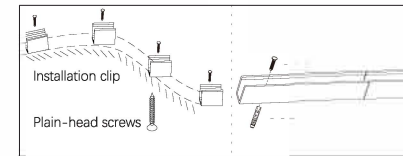

Install by clips or alu profile: fix installation clips or profile by screws, 2~3 pcs of clip per meter (Note: put clip-clip or profile-profile at a line, do not use hump-head screw).

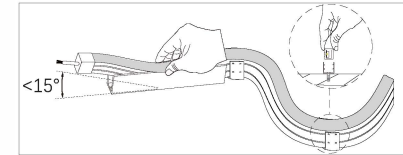

Press neon light into installation clips or profile, could do right and left bend, the angle of up and down bend should not be higher than 15°.

FAQ

Q: Warranty ?
A: under normal condition and proper handling, 3-year warranty. We will repair or replace products covered under this warranty with components at our company's election or discretion if quality defect to be confirmed.

Q: What conditions would make warranty to be invalid ?
A: 1. Do not comply to instruction or user manual to misuse products to damage products.
 2. Disassemble products to damage products.
 3. The products are damaged or deformation badly.

Q: Why whole neon light does not light or no color changing ?
A: Double check if it is power-on, if wiring correctly, if there is short-circuit, if power fuse burned etc. correct it if finding anything wrong.

Q: Why part of neon lights do not light or no color changing ?
A: Double check if there is power supply to close to neon light, make sure the position of power supply to close to neon light, if part of circuit of neon light with error, correct it if finding anything wrong.

Q: Why the brightness of neon lights is difference or low brightness (not including DMX512 RGB addressable neon light) ?
A: Double check if there is power overload, if yes, change or add power supply. Check if the cables are too thin, if yes, change bigger cables or adjust the position of power supply to close to neon light, make sure the supply voltage for each 5 meters of neon light is higher than 95% of rated voltage. Check if there are too many series connections of neon lights, if yes, change series connections and make sure there is enough voltage supply to neon lights.

Q: Why neon lights are twinkle(not including DMX512 RGB addressable neon light) ?
A: Double check if there is any poor contact, if the power of neon lights is higher than power supply, if yes, improve contact or change power supply with higher power.