

Atlas Grow Light

Description:

Our Atlas Grow Light is available in an array of wattages from 12-48W. This fixture can be mounted vertically, horizontally or surface mounted to help facilitate the growing process from any angle.

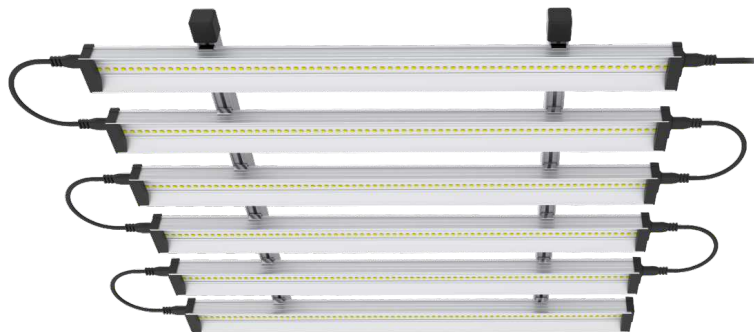

Features:

- Input Voltage: AC110-277V, 50/60Hz
- Wattage: 12W - 48W
- Lumens: 150 LM/W
- PPE: 2.0umol/J
- THD: <20%
- Power Factor: >0.95
- Operating Temperature: -77°F ~ +104°F
- Available Sizes: 12IN, 18IN, 22IN, 34IN, or 46IN
- L70 Lifetime: >50,000 hours
- 7 Year Warranty



Applications:

- Surface Mounted
- Vertical Stand
- Horizontal Stand

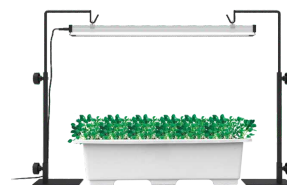

Ordering Key:

ILGWAGAL				
SERIES NUMBER	WATTAGE / LUMENS	CCT	FINISH	ADDITONAL OPTIONS
ILGWAGAL	12W - 1,691			
	18W - 2,503			
	24W - 3,306			
	36W - 4,989			
	48W - 6,611			

SAMPLE ITEM NUMBER: ILGWAGAL 36W

Photometrics:

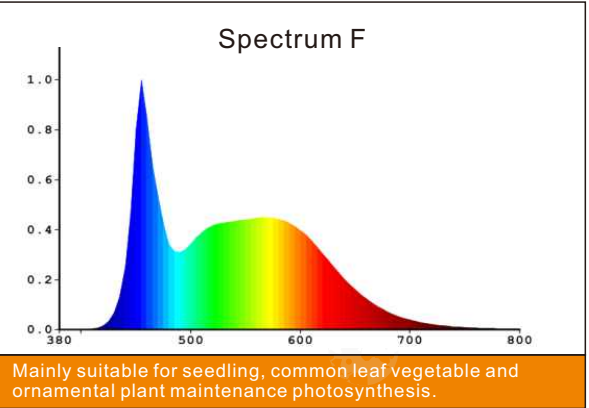
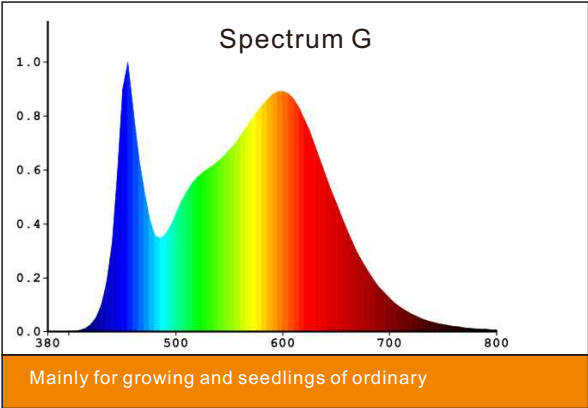
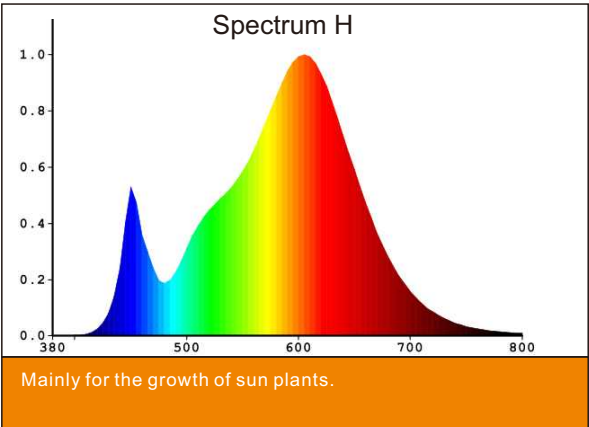
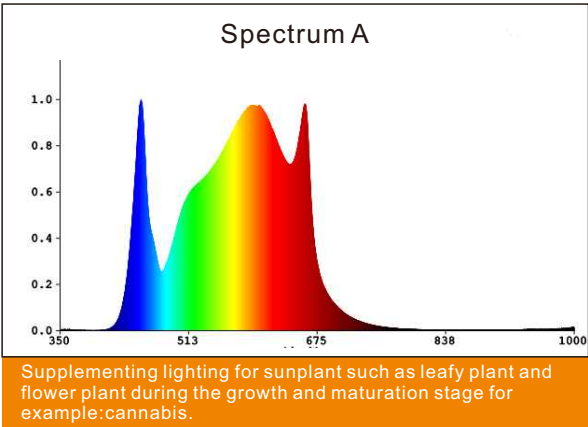

Dimensions:

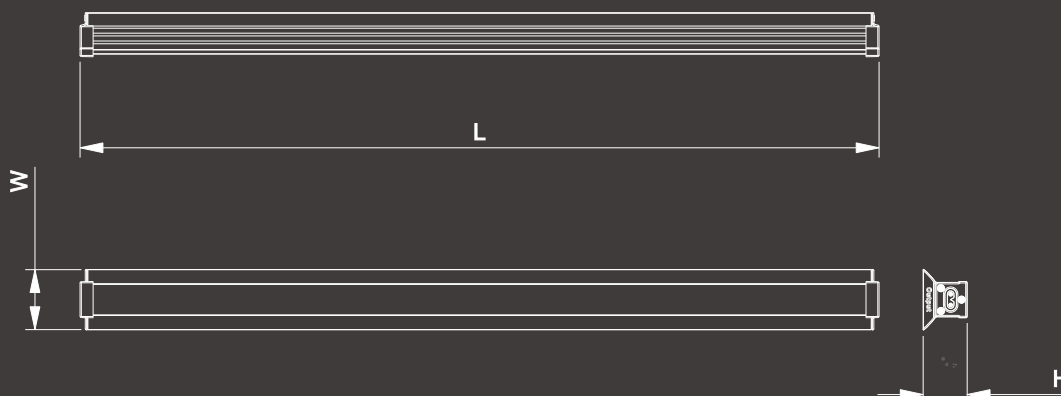

Wattage	L	W	H
12W	305mm (12")	46.3mm (1.8")	32.7mm (1.2")
18W	475mm (18.7")	46.3mm (1.8")	32.7mm (1.2")
24W	575mm (22.6")	46.3mm (1.8")	32.7mm (1.2")
36W	875mm (34.4")	46.3mm (1.8")	32.7mm (1.2")
48W	1175mm (46.2")	46.3mm (1.8")	32.7mm (1.2")

Item Number	Power (W)	Lumens (LM)	PPFD (High)	PPFD (Low)
LGWAGAL	12	1691.5	24.2	320.9
	18	2503.1	36	316.3
	24	3306.9	47.3	357
	36	4989.7	72	334.3
	48	6611.2	95.7	341.7



Installation:

Single Bar

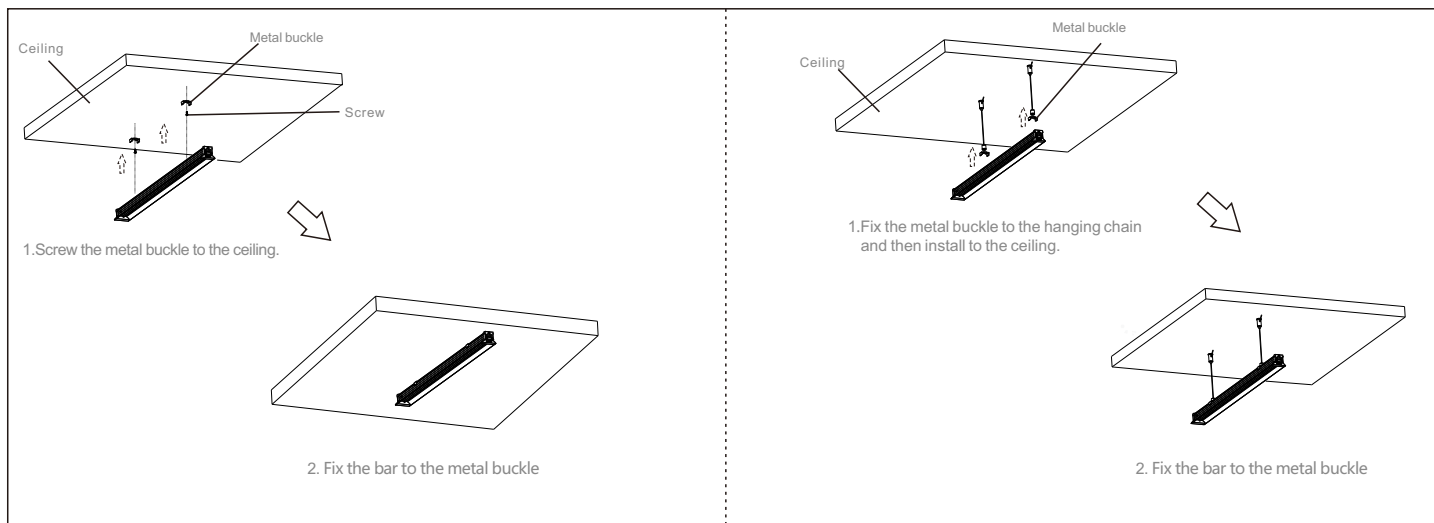

Splicing installation instruction

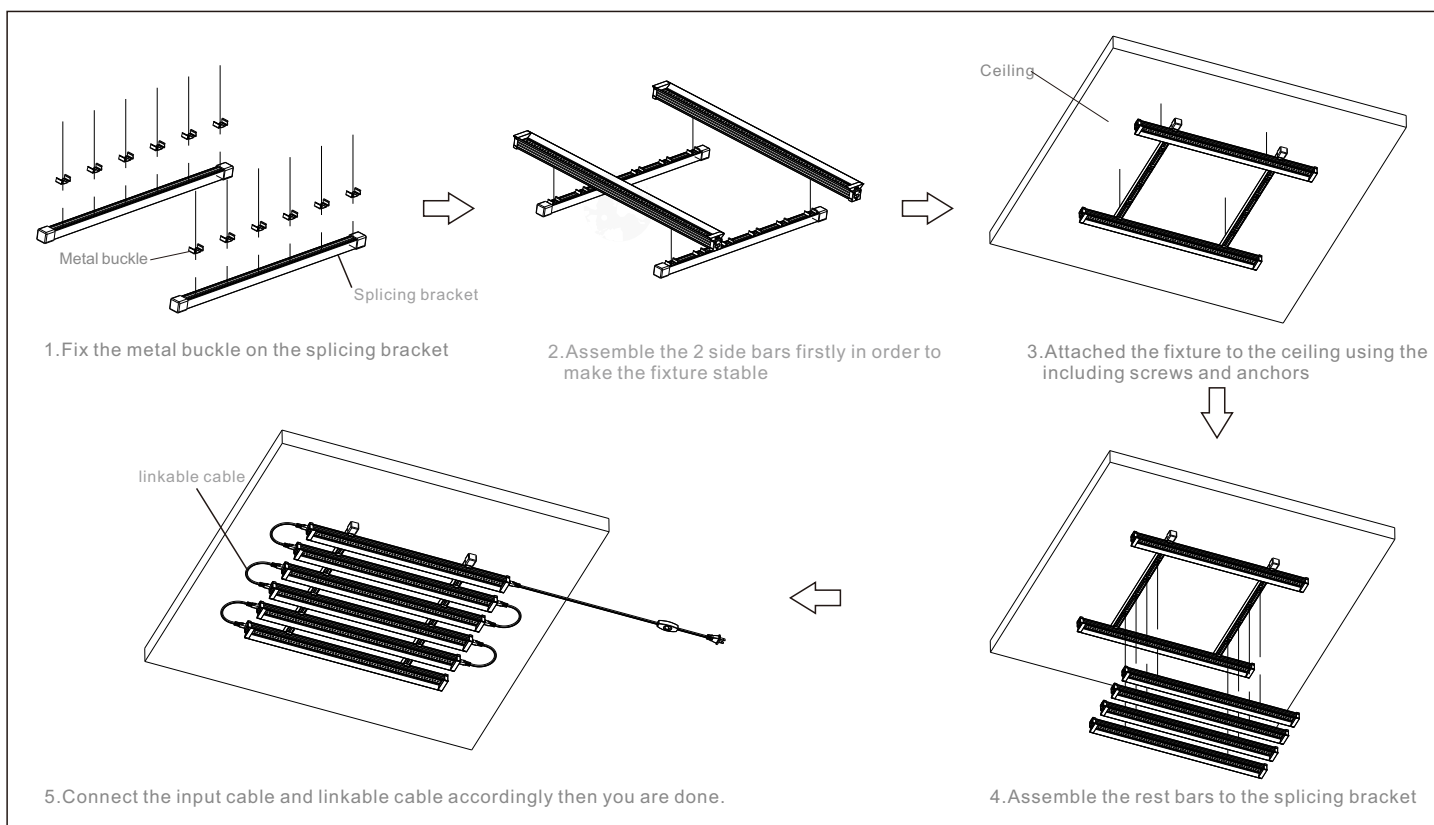

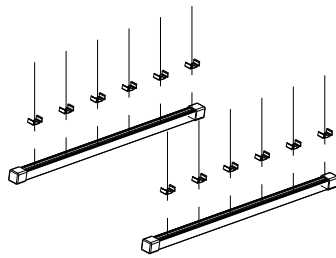

1. Fix the metal buckle on the splicing bracket

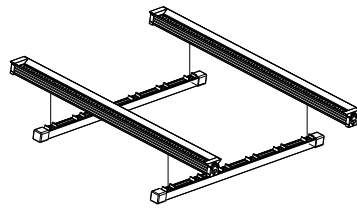

2. Assemble the 2 side bars firstly in order to make the fixture stable

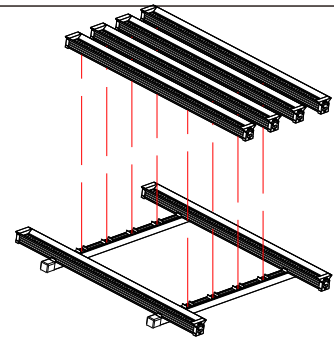

3. Assemble the rest bars to the splicing bracket

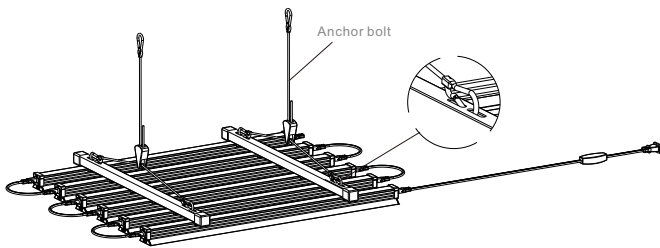

5. lock the hook of the sling to the splicing bracket and then you are done.

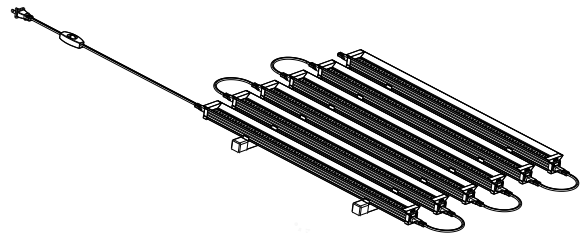

4. Connect the input cable and linkable cable accordingly

Connections:

