



i-LUMINOSITY
LED LIGHTING FIXTURES

Date:	_____
Project:	_____
Price:	_____

Vianney LED Downlight

Description:

The Vianney LED downlight is one of our compact designs. An aluminum housing offers great thermal management. This fitting can be used for retrofit or new construction installation. Suitable for commercial and residential applications like offices, supermarkets, shops, schools, hotels, restaurants, & workshops.

Features:

- Input Power: 100V-277V 50/60Hz
- Size: 4IN, 6IN, 8IN, or 10IN
- Beam Angle: 40°
- CRI >90
- CCT: 2700K, 3000K, 3500K, 4000K, 5000K
- IP20
- 0-10V dimming
- L70 Lifetime: >50,000 hours.
- UL Rated & Energy Star Approved
- 7 Year Warranty.



Date:	_____
Project:	_____
Price:	_____

Ordering Key:

SERIES NUMBER	WATTAGE/ SIZE /LUMENS	CCT	FINISH	ADDITIONAL OPTIONS
ILDLVNUP	415- 15W/ 4IN / 1,000	2 - 2700K	WH - WHITE	DIM - 0-10V DIMMING
	420- 20W / 4IN / 1,150	3 - 3000K		
	620 - 20W / 6IN / 1,500	35 - 3500K		
	625 - 25W/ 6IN / 1,800	4 - 4000K		
	630- 30W/ 6IN / 2,300	5 - 5000K		
	642 - 42W/ 6IN / 3,300			
	825- 25W / 8IN / 1,700			
	835- 35W / 8IN / 2,700			
	842- 42W/ 8IN / 3,400			
	142 - 42W/ 10IN / 3,400			
	150- 50W / 10IN / 3,800			

SAMPLE ITEM NUMBER: ILDLVNUP 620 3 WH DIM

Dimensions:

4 IN:

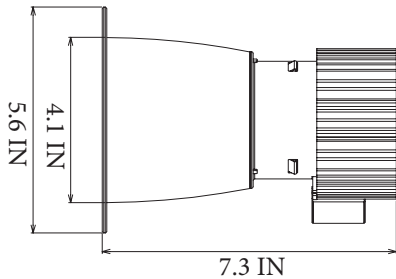

- 15W or 20W: 5.6 IN x 7.3 IN

6 IN:

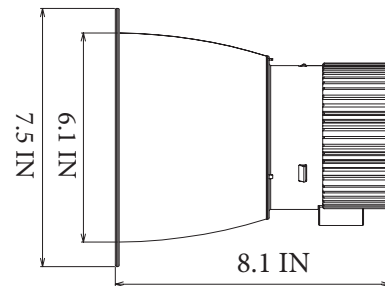

- 20W, 25W, 30W, or 42W: 7.5 IN x 8.1 IN

8 IN:

- 25W, 35W or 42W: 9.3 IN x 8.7 IN

10 IN:

- 42W or 50W: 10.9 IN x 8.7 IN



Date:	_____
Project:	_____
Price:	_____

Features & Specifications:

Intended use

1. Wood joist or T-bar installation.
2. Suitable for new construction in commercial applications where uniform light distribution is required.
3. Keep the bracket 3inch distance away from any other fixture when installation.
4. Surrounding thermal protection materials around the bracket should be qualified.

Structure introduction:

1. Overall structure is made of galvanized sheet, fire-proof and heat resistant.
2. The junction box is detachable for easy wiring.
3. 4" 6" 8" 10" are optional.
4. 2 sets extended bars provided for the bracket, could be extended and shortened within 13-3/4" - 24".
5. There are four 7/8" knockouts with slots for pryout for connection on the junction box. Spare knockouts with slots: Two 1-1/8", another two 9/16" on the left size.
6. No.18 AWG ground wire is provided on the bracket.

Product Dimensions:

IL-HOLDER(4 inch)

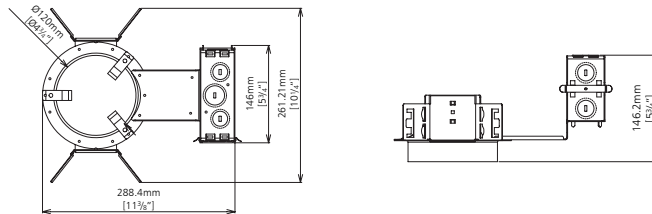

IL-HOLDER(6 inch)

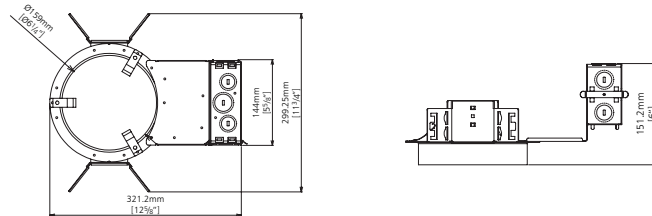

IL-HOLDER(8 inch)

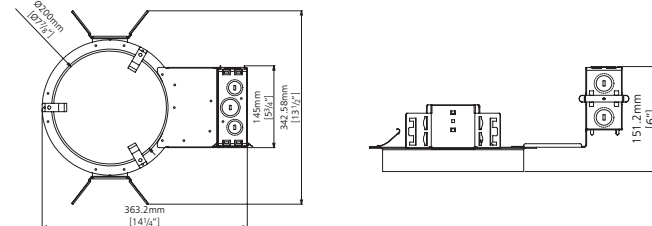

IL-HOLDER(10 inch)

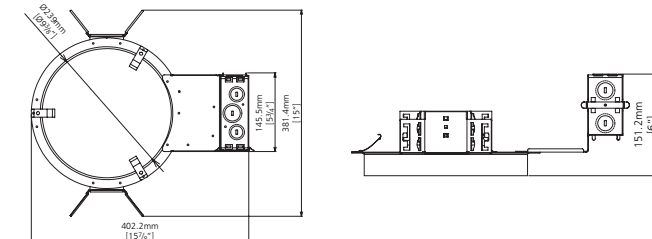

Date:	_____
Project:	_____
Price:	_____

Installation Instructions:

Step 1:
Fix mounting clips (A part) on two sides of the bracket by screws.

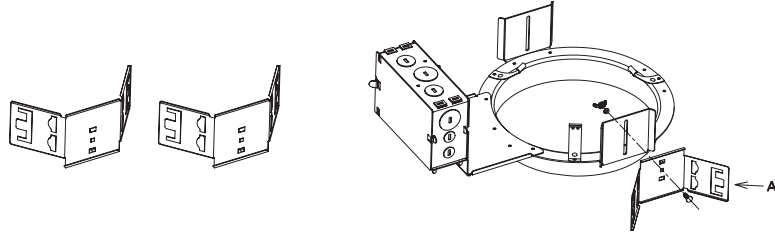

Step 2:
Two types extended bars are optional, narrow type (B.C) and wide type (D.E). Plug extended bars into mounting clips on the two sides.

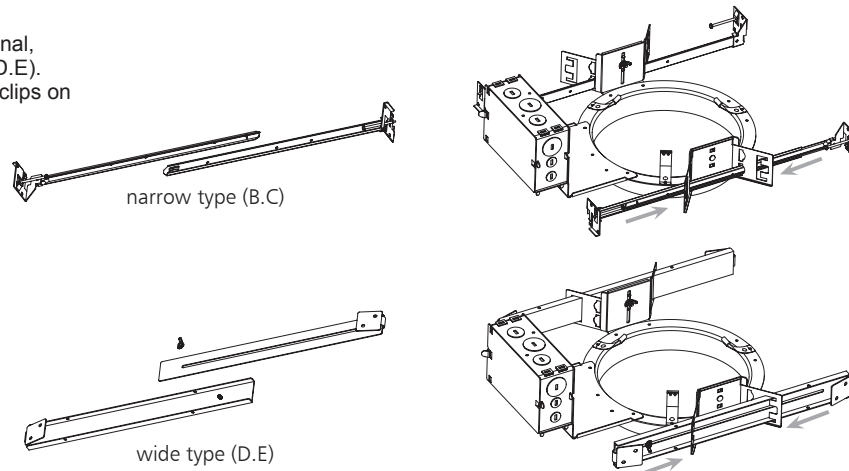

Step 3:
Install whole installation kit onto hanging bracket, fix extended bars with nails and adjust bracket position as shown.

