

Installation Procedure

WARNING ⚡

1. Switch off before installation / maintenance.
2. Switch on only after complete installation and examination of the circuit.
3. Professional electrician for installation and maintenance only.

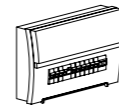

Turn Off power supply before starting any installation. Read instructions & check you have all the tools & accessories to complete the installation correctly.

How to install

Step 1

Take out the lamp, remove screws on bottom, take out the bottom cover.

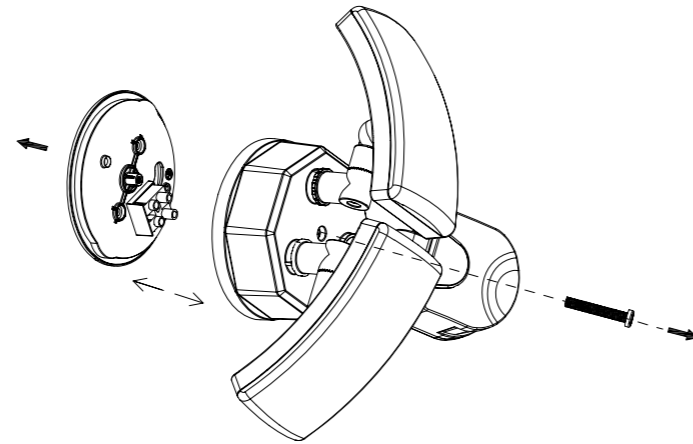

Step 2

Connect the earth wire to the mounting bracket with the terminal block, then lock the bracket into the junction box.

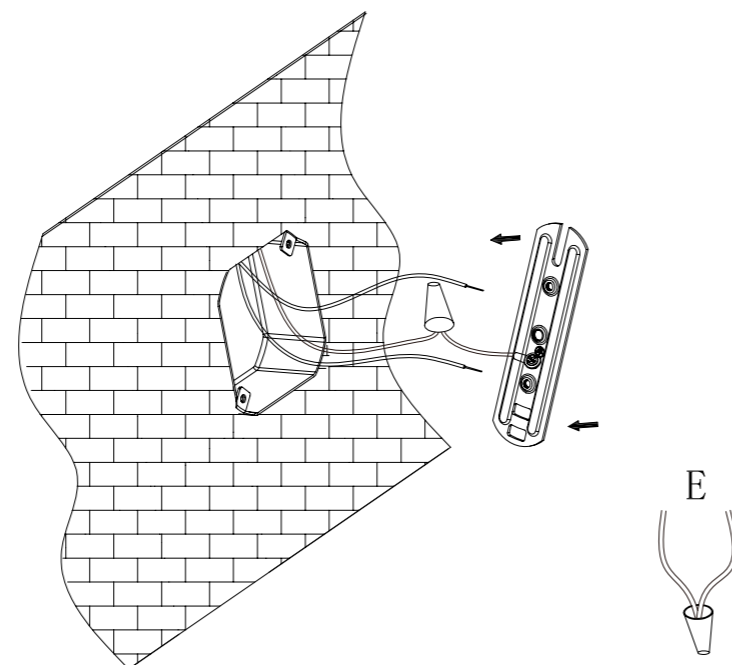

Step 3

Lock the back cover to the mounting bracket.

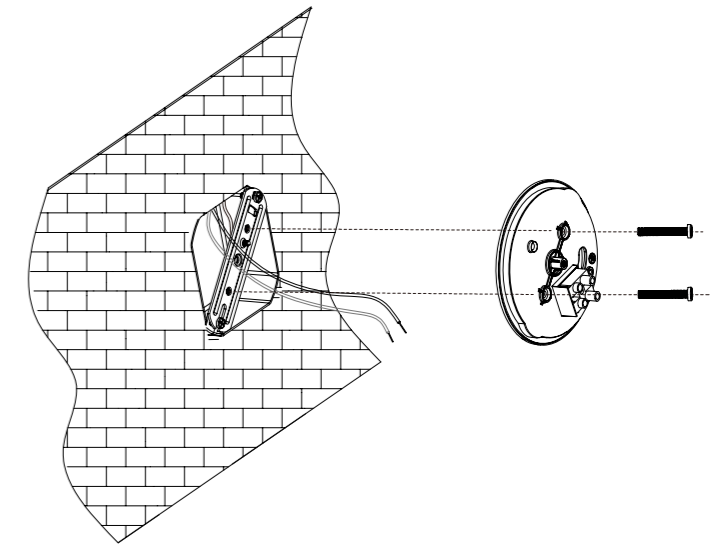

Step 4

Connect AC wire correspondingly.

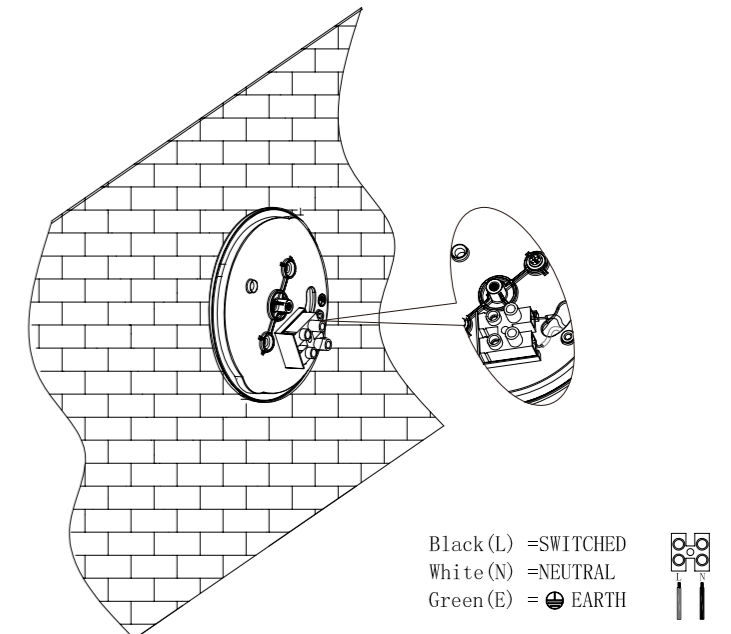

Step 5

Choose sensor mode by DIP switch, If with 3CCT function, choose preferred CCT by slide switch.

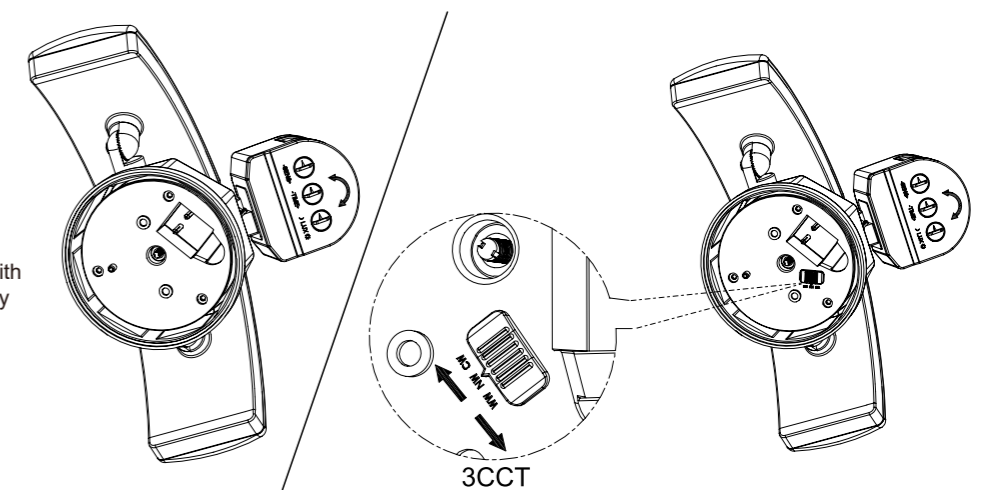

Step 6

Loosen the screw on the swing, adjust the required light direction, then lock the screw on the swing arm.

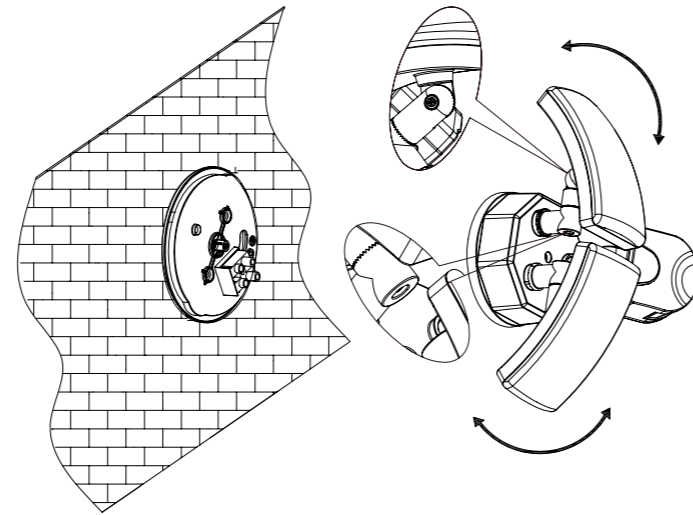

Function description

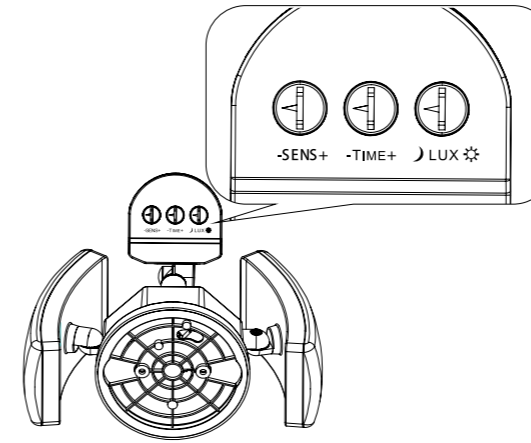

1. Switch on the power, PIR sensor will enter into "WARN-UP" stage within 30s, then start sensor mode.
 2. After PIR sensor start working, can do manually adjustment as below:
 - 2.1 Adjust sensitivity by the "SENS" knob, "+" is strengthen sensitivity, "-" is weaken the sensitivity. Notice: Sensitivity means sensor distance.
 - 2.2 Adjust hold time by the "TIME" knob, 5±3S—12±2Min, "+" is add time, "-" is reduce time.
 - 2.3 Adjust lighting control mode by "LUX" knob: ☀ means both daytime and night are in sensing status, 🌙 means only sensor during night.
- Users can set the above three parameters as needed.

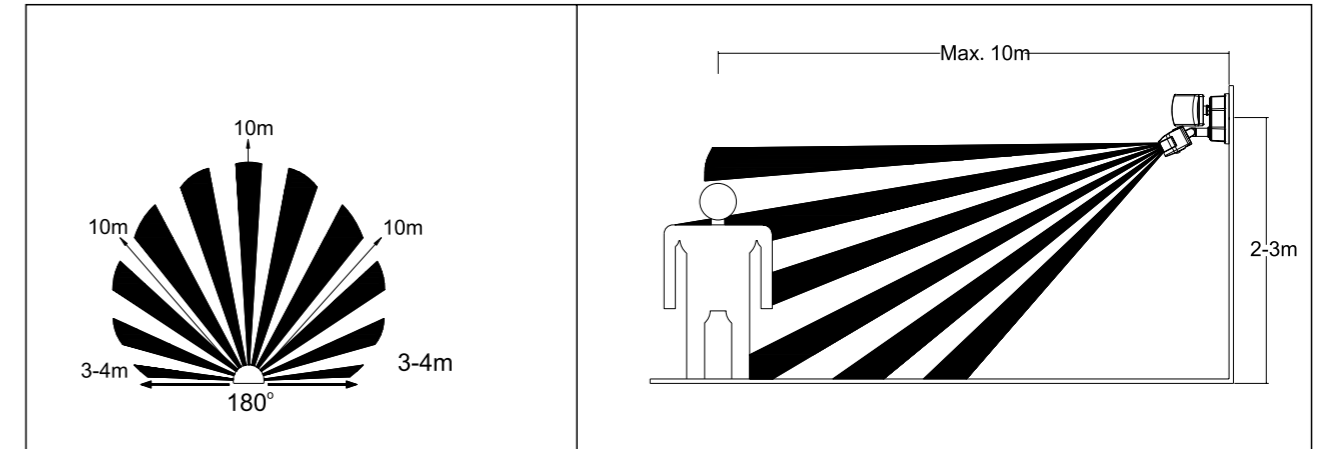

Step 7

Align the lamp body with the bottom cover, tighten the screw through the lamp body, then adjust the sensing center area.

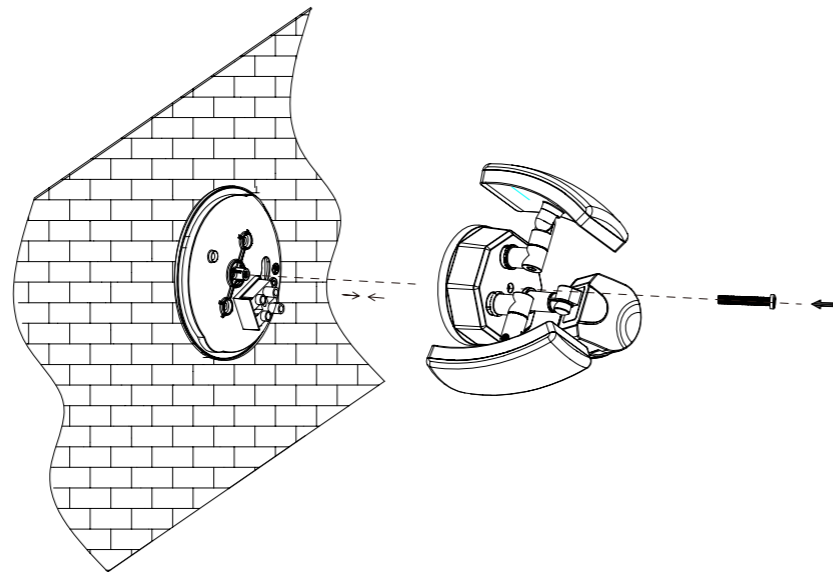

Step 8

Finally, add some waterproof glue to the mounting periphery, turn on.

