

Bedford Linear Pendant Installation Instructions:

◆ Pendant accessories

- ① Expansion plug-RUS / 2 pcs
- ② Self-tapping screw / 2 pcs
- ③ Davit / 2 pcs
- ④ Pendant wire/ 2 pcs
- ⑤ Hanging head / 1 pcs
- ⑥ Pedan clip / 2 pcs

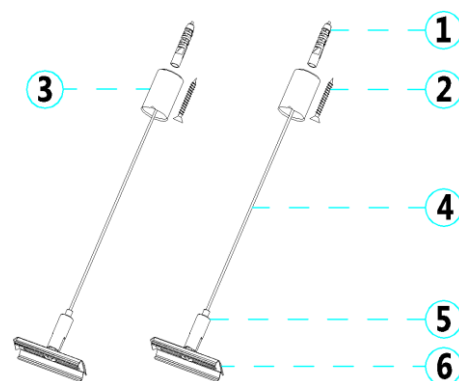

Installation step:

(1) Fix pendant wires on ceiling

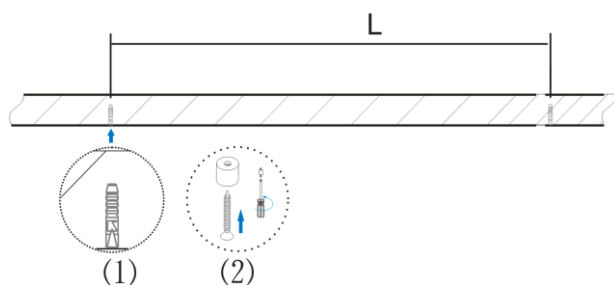

(2) Press pendant clips onto the back of linear light

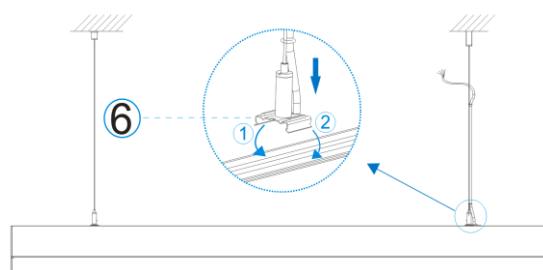

(3) Connect the lamp input line in outlet box according to the color mark corresponding to the city electricity and dimming signal line, strain relief device need to be used before cord entry the outlet box during installation.

(4) Complete installation

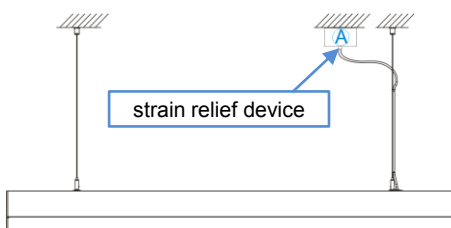
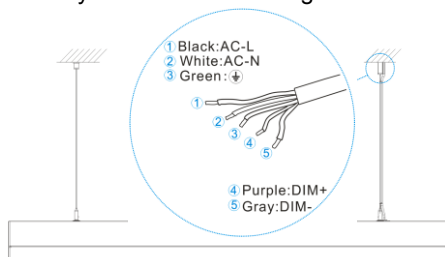

Explain: connect to ①、②、③ only if do not need to use dimming function, no need to connect ④、⑤

Note: A outlet box and strain relief device (prepare by user)

Pendant installation parameter

| Size | 1230mm (4.04Ft) | 1839mm (6.03Ft) | L2449mm (8.03Ft) |
|------------------------|--------------------|---------------------|---------------------|
| φ6mm/hole scale by "L" | 995mm(3.26Ft)±10mm | 1340mm(4.40Ft)±10mm | 1950mm(6.40Ft)±10mm |

Attention:

- Please read instruction seriously before assembly & installation, lighting fixture must be assembled according to instruction by qualified & licensed electrician. Anything unclear please contact to manufacturer or local distributor.
- The electric source must be cut off before assembly & installation or remove.
- The lighting fixture is used only for indoor, the aim to avoid the risk of fire or electric shock, please do not use it for outdoor, vibrant, dusty and high humidity environment.
- The aim to make sure not to shorten the life time of lighting fixture and keep safety, please do not modify, add or change any component.
- Please cut off electric source immediately if any abnormality occur so that avoid any danger or malfunction, and lighting fixture must be checked and repaired by professional technician.

Bedford Linear Wall Mounting Instructions:

◆ Recessed accessories

- ① Expansion plug-RUS / 2 pcs
- ② Wall mounting clip / 2 pcs
- ③ Self-tapping screw / 2 pcs
- ④ M7 screw nut / 2 pcs
- ⑤ M4 screw bolt / 2 pcs
- ⑥ Pedan clip / 2 pcs
- ⑦ M7 screw bolt / 2 pcs

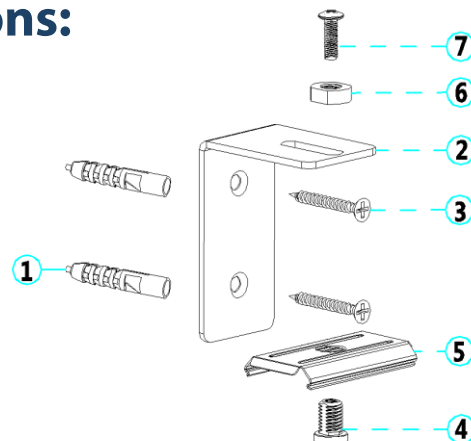

Installation step:

(1) Fixed wall mounting clips onto wall

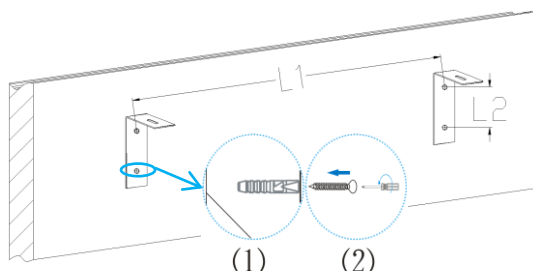

(3) Connect the lamp input line in outlet box according to the color mark corresponding to the city electricity and dimming signal line, strain relief device need to be used before cord entry the outlet box during installation.

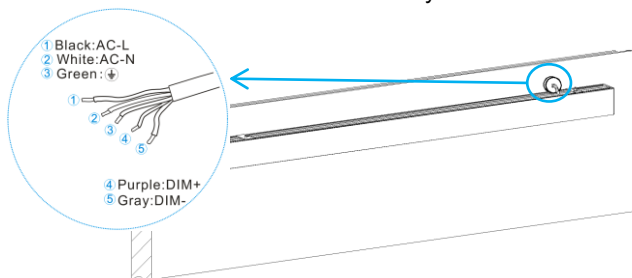

Explain: connect to ①、②、③ only if do not need to use dimming function, no need to connect ④、⑤

(2) Fixed linear light fixture on wall mounting bracket

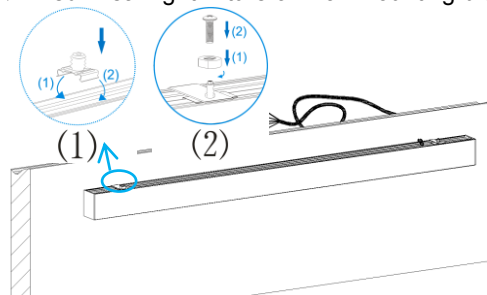

(4) Complete installation

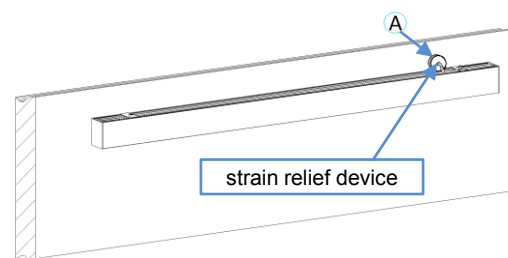

Note: A outlet box and strain relief device (prepare by user)

Wall mounting installation parameter

| Size | 1230mm (4.04Ft) | 1839mm (6.03Ft) | L2449mm (8.03Ft) |
|------------------------|--------------------|---------------------|---------------------|
| φ6mm/hole scale by "L" | 995mm(3.26Ft)±10mm | 1340mm(4.40Ft)±10mm | 1950mm(6.40Ft)±10mm |
| φ6mm/hole scale by "L" | 30mm | | |

Attention:

- Please read instruction seriously before assembly & installation, lighting fixture must be assembled according to instruction by qualified & licensed electrician. Anything unclear please contact to manufacturer or local distributor.
- The electric source must be cut off before assembly & installation or remove.
- The lighting fixture is used only for indoor, the aim to avoid the risk of fire or electric shock, please do not use it for outdoor, vibrant, dusty and high humidity environment.
- The aim to make sure not to shorten the life time of lighting fixture and keep safety, please do not modify, add or change any component.
- Please cut off electric source immediately if any abnormality occur so that avoid any danger or malfunction, and lighting fixture must be checked and repaired by professional technician.

Bedford linkable Linear Assembly Instructions:

◆ Components

- ① Main profile
- ② Light source holder (carrier) □
- ③ Diffuser
- ④ End cap
- ⑤ anti-lightleak clip
- ⑥ Straight connector
- ⑦ Screw driver
- ⑧ 5-core or 3-core SJT 18AWG input cable with male terminal block (8EDGKRB, DEGSON ELECTRONICS CO LTD) prepare by user
- ⑨ Connection cable

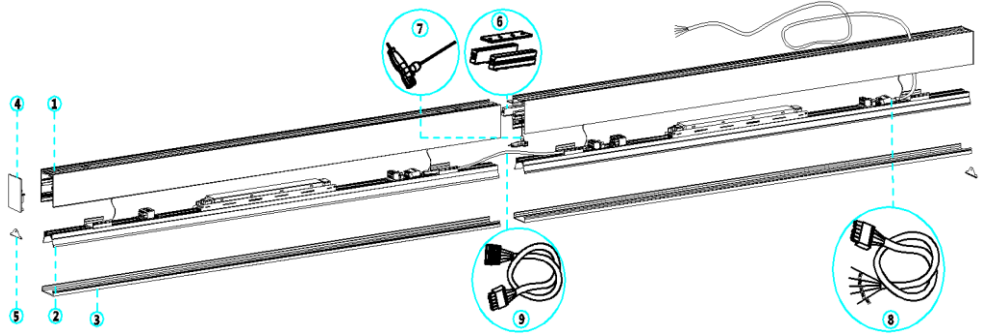

Assembly

- (1) Remove diffuser, carrier and end cap in sequence of instructor (2) Insert straight connectors and then fixed connectors

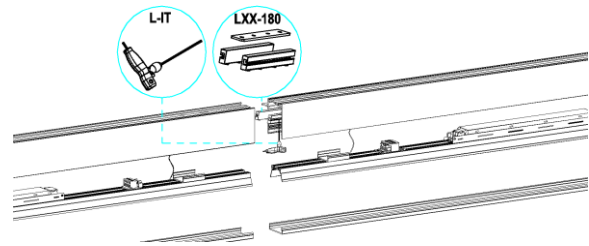
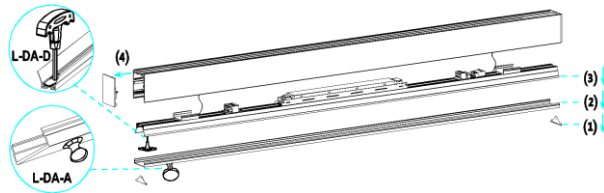

- (3) Connect AC input cable and connection cable

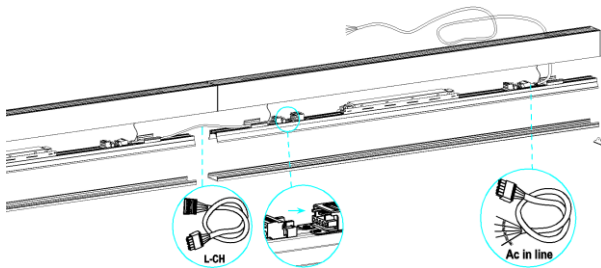

- (4) The power supply cord should be fixed by the strain relief device, and the signal line connect according to the color mark corresponding to the city electricity and dimming signal line

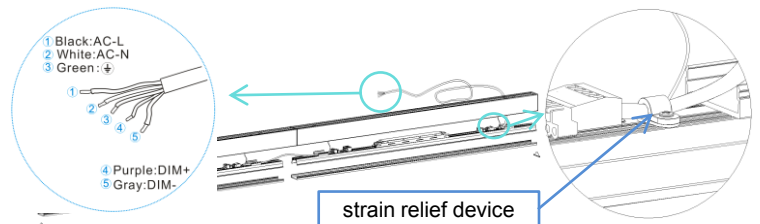

- (4) Assemble carrier, diffuser and anti-lightleak clips

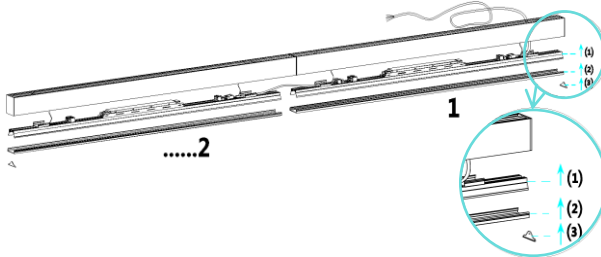

- (6) Complete assembly

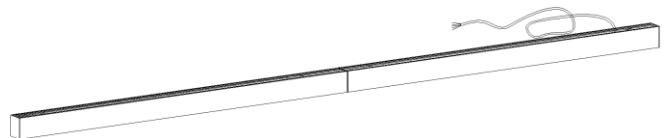

Attention:

1. Please read instruction seriously before assembly & installation, lighting fixture must be assembled according to instruction by qualified & licensed electrician. Anything unclear please contact to manufacturer or local distributor.
2. The electric source must be cut off before assembly & installation or remove.
3. The lighting fixture is used only for indoor, the aim to avoid the risk of fire or electric shock, please do not use it for outdoor, vibrant, dusty and high humidity environment.
4. The aim to make sure not to shorten the life time of lighting fixture and keep safety, please do not modify, add or change any component.
5. Please cut off electric source immediately if any abnormality occur so that avoid any danger or malfunction, and lighting fixture must be checked and repaired by professional technician.

Please read instruction manual before installation:

◆ **Decomposition of product parts**

- | | |
|---|--|
| ① Suspension kits: ILBVLPTB-NPF-6M 11 pcs | ⑤ Suspension kits: ILBVLPTB-PF2-6M:1 set |
| ② Fixture: A-45L 2pcs, B-45R 2pcs, C-45D 2pcs | ⑥ Power cable: ILBVPSM-6FT 1 pc |
| ③ L corner connectors: ILBVL-90L 4 sets | ⑦ Power connectors: ILBVLCH 5pcs |
| ④ Extending connectors: ILBVL45-180 2 sets | ⑧ Lens: A:2pcs, B: 2pcs, C:2pcs |

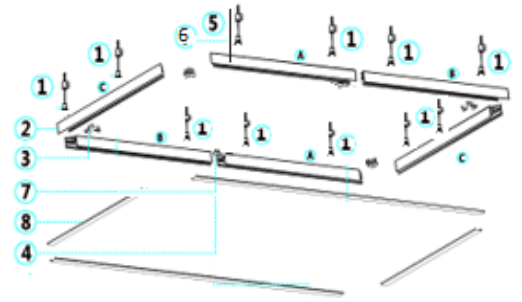

Installation Steps:

1. Remove lens and light source holder by Tool ILBVLDA.

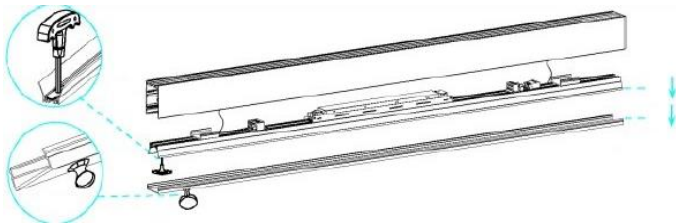

2. Connect and fix the profile A and B, and then connect and fix the channel C on both sides.

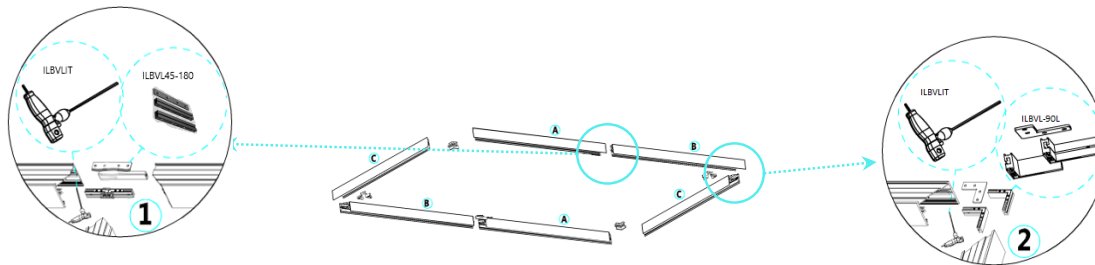

3. Fix the safety cord and ground wire on light source holder.

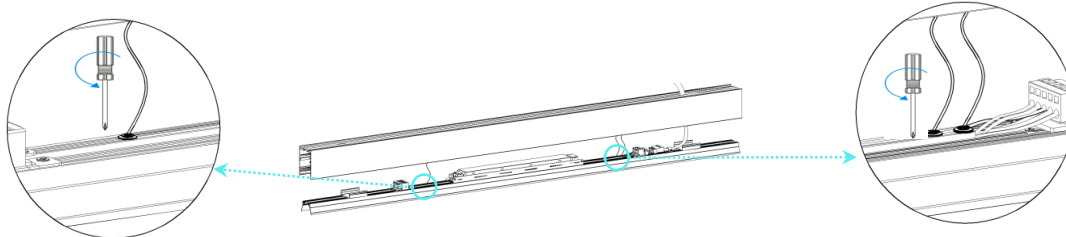

4. Connect the power feed (top left Fixture A with 2 hole canopy suspension kits ILBVLPTB-PF2-6M) by ILBVPSM-6FT, and use power connector ILBVLCH to connect wiring harness one by one.

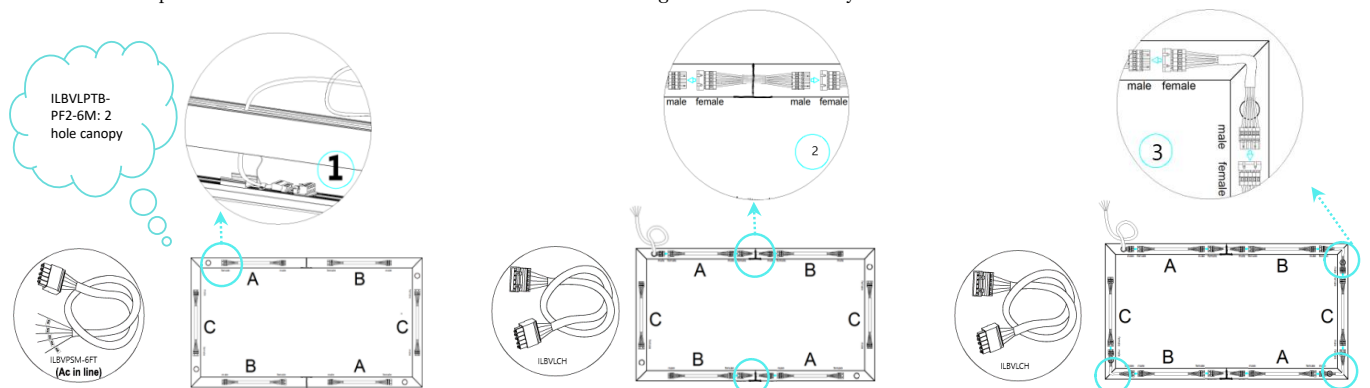

Rectangular Installation manual - Bedford Linear light

5. Install the light source holder from C to A only by one, and then install the lens from A to C one by one.

The rectangle fixture assembly finish.

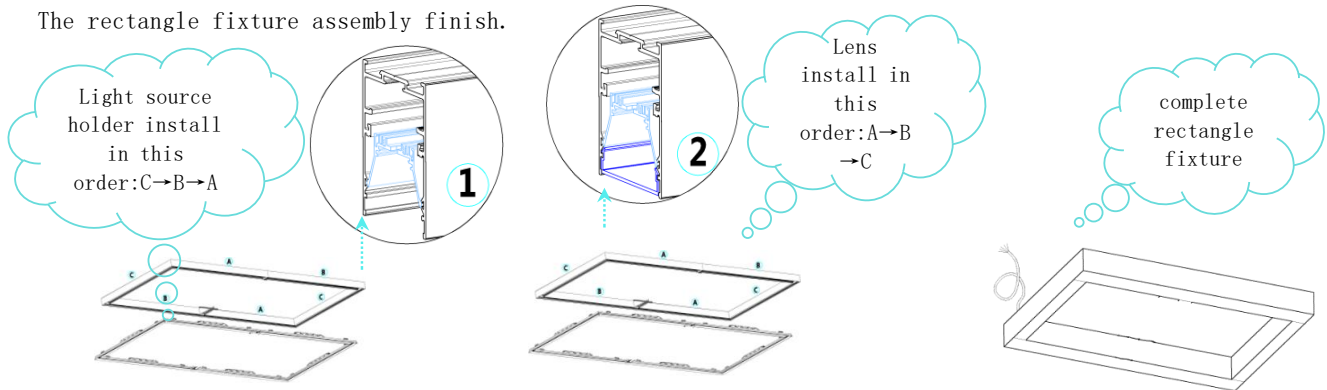

6. Install the canopy in right position, the below dimensions are for customer reference ;

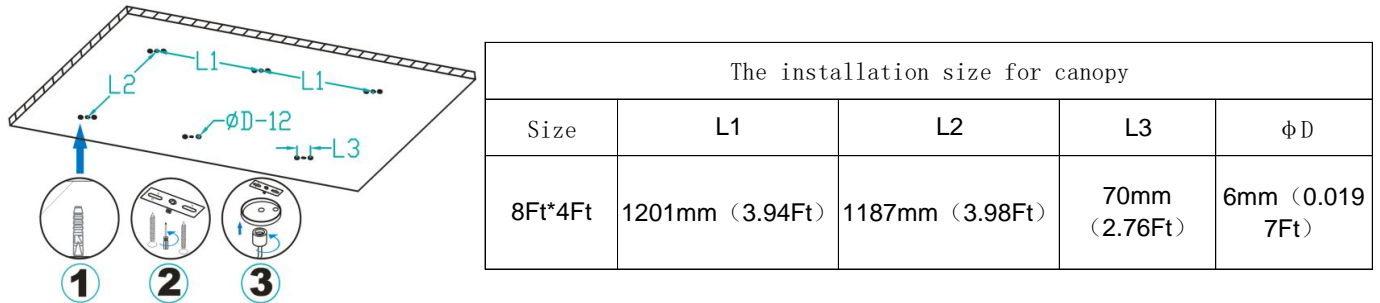

7. Fix clips on the back of channel, and adjust the right height and position, Lock it.

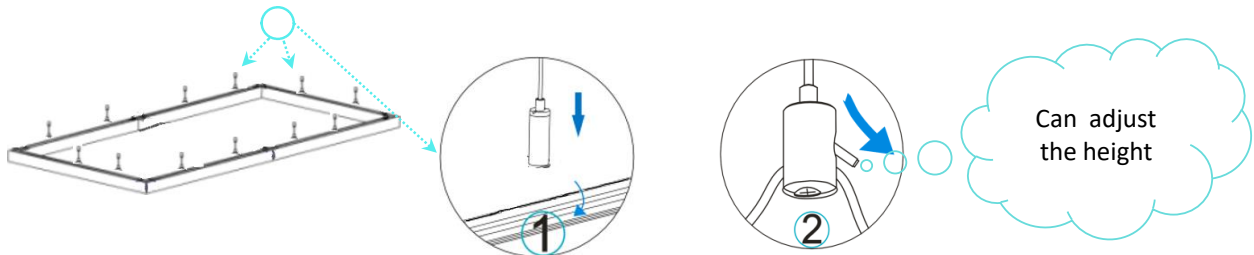

8. Connect AC power feed correctly.

9. Finish.

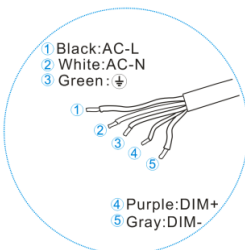

Attention:

1. Please read instruction seriously before assembly & installation, and lighting fixture must be assembled according to instruction by qualified & licensed electrician. Anything unclear please contact to manufacturer or local distributor.
2. the electric source must be cut off before assembly & installation or remove.
3. The lighting fixture is used only for indoor, the aim to avoid the risk of fire or electric shock, please do not use it for outdoor, vibrant, dusty and high humidity environment.
4. The aim to make sure not to shorten the life time of lighting fixture and keep safety, please do not modify, add or change any component.
5. Please cut off electric source immediately if any abnormality occur so that avoid any danger or malfunction, and lighting fixture must be checked and repaired by professional technician.

Please read instruction manual before installation:

◆ Decomposition of product parts

- ① Suspension kits: ILBVLPTB-NPF-6M 6pcs
- ② Fixture: A-45L 2pcs, B-45R, C-45D 2pcs
- ③ L corner connectors: ILBVL-90L 4 sets
- ④ Extending connectors: ILBVL45-180 2 sets
- ⑤ Suspension kits: ILBVLPTB-PF2-6M: 6 pcs
- ⑥ Lens: A:2pcs, B: 2pcs, C:2pcs

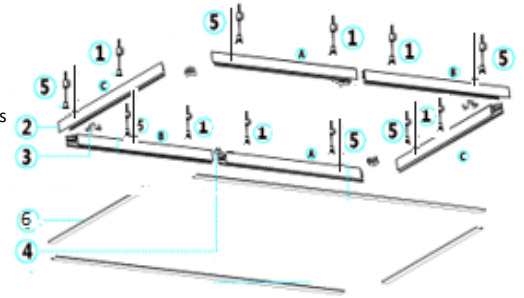

Installation Steps:

1. Remove lens and light source holder by Tool ILBVLDA.

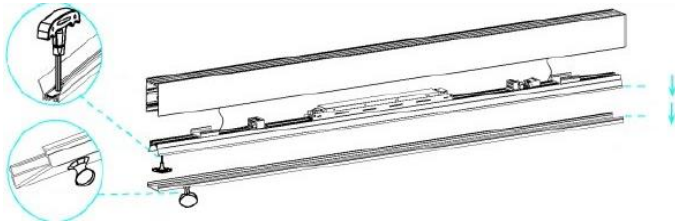

2. Connect and fix the profile A and B, and then connect and fix the channel C on both sides.

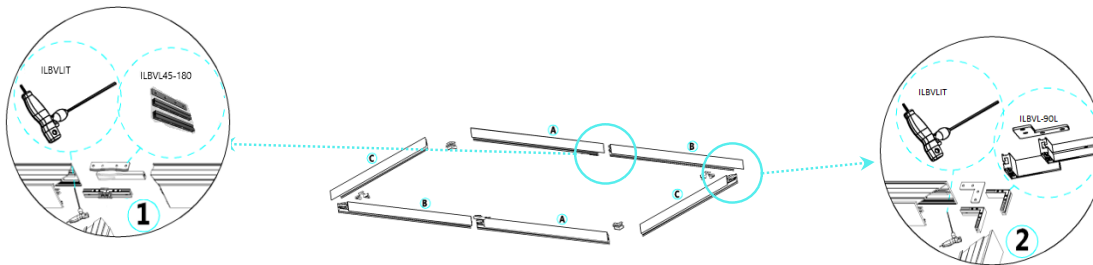

3. Fix the safety cord and ground wire on light source holder.

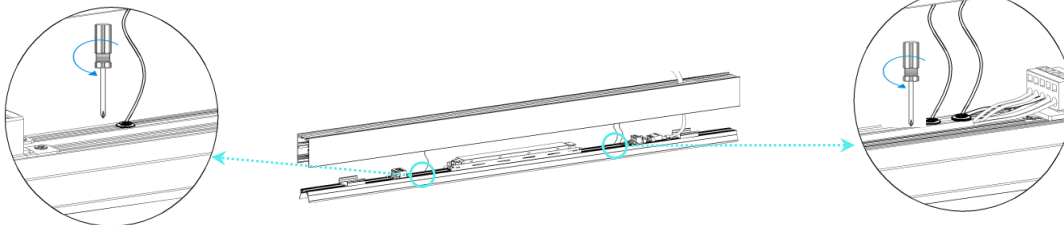

4. Connect the power feed, 2 hole canopy suspension kits ILBVLPTB-PF2-6M for power cable and EM cable,

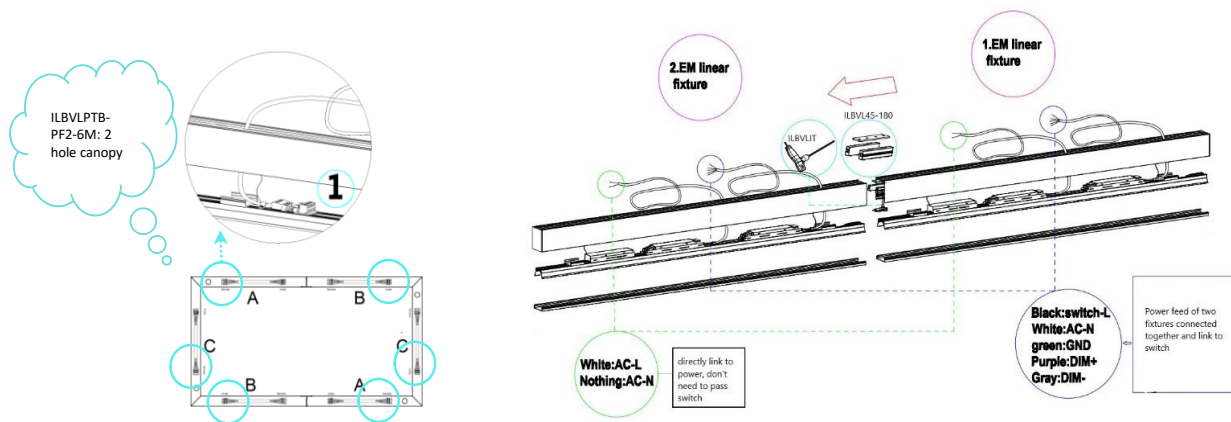

Rectangular Installation manual-Bedford Linear light with Emergency kits

5. Install the light source holder from C to A only by one, and then install the lens from A to C one by one.

The rectangle fixture assembly finish.

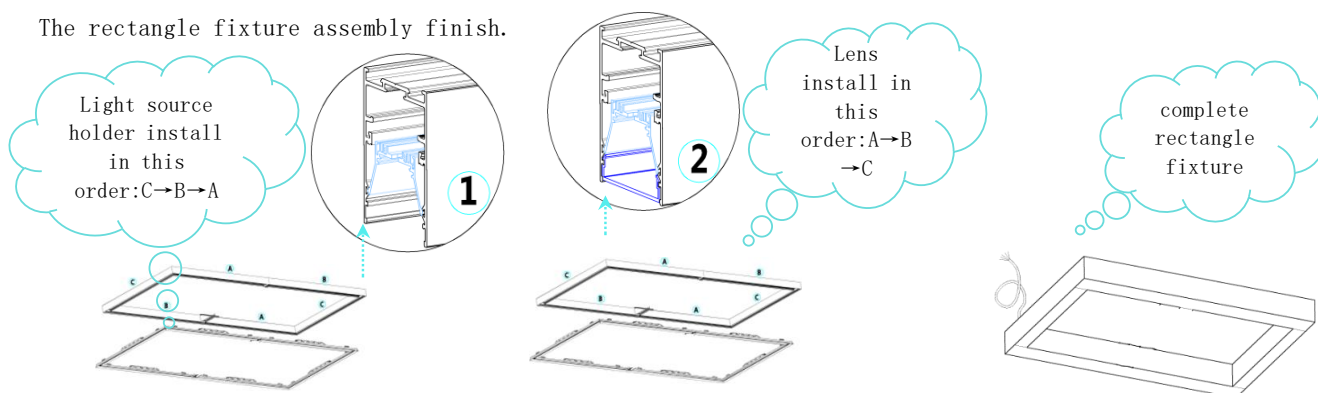

6. Install the canopy in right position, the below dimensions are for customer reference ;

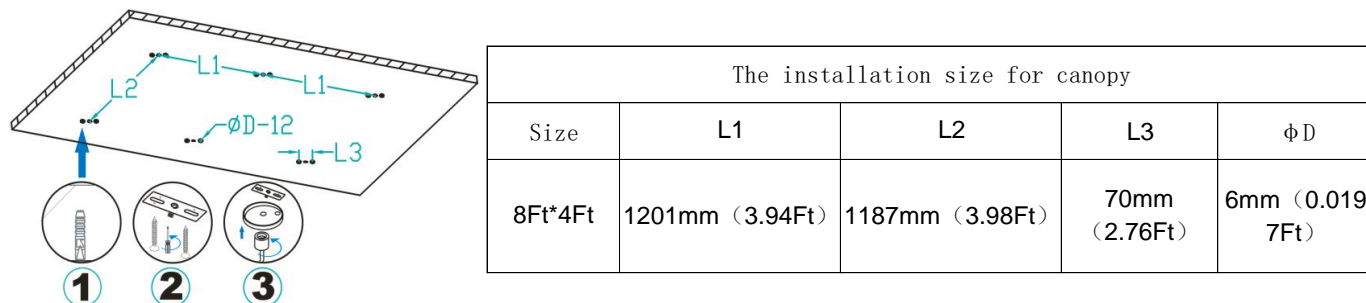

7. Fix clips on the back of channel, and adjust the right height and position, Lock it.

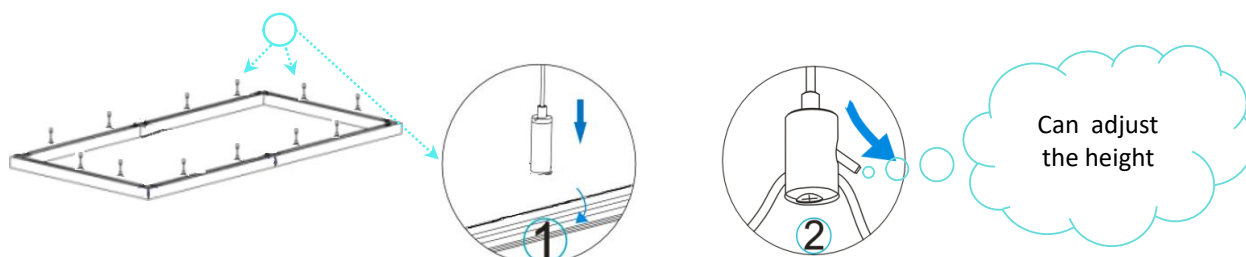

8. Connect AC power feed correctly.

9. Finish.

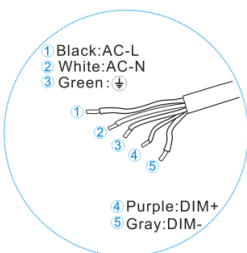

Attention:

1. Please read instruction seriously before assembly & installation, and lighting fixture must be assembled according to instruction by qualified & licensed electrician. Anything unclear please contact to manufacturer or local distributor.
2. the electric source must be cut off before assembly & installation or remove.
3. The lighting fixture is used only for indoor, the aim to avoid the risk of fire or electric shock, please do not use it for outdoor, vibrant, dusty and high humidity environment.
4. The aim to make sure not to shorten the life time of lighting fixture and keep safety, please do not modify, add or change any component.
5. Please cut off electric source immediately if any abnormality occur so that avoid any danger or malfunction, and lighting fixture must be checked and repaired by professional technician.