

Date:	_____
Project:	_____
Price:	_____

# CHELSEA LINEAR LIGHT

## Description:

Our Chelsea Linear Light ensures an even illumination across any surface. Easily **LINKABLE** to create any length or shape. With an IP40 rating and multiple mounting options, this fixture is perfect for offices, retail locations, or lobbies.

## Features:

- Input Power: 100~240VAC
- Housing Material: Aluminum + PC cover
- Wattage: 21W/31W/43W/61W
- 5.3 W/FT
- 745 LM/FT
- IP Rating: IP40
- CRI >90
- Available Color Options: 2700K, 3000K, 3500K, 4000K or 6000K.
- Available Mounting Options: Surface, Wall, or Suspended.
- Beam Angle: 96°
- Custom lengths available upon request.
- L70 Lifetime: >50,000 hours.
- Available Finish Options: Silver, White, Black, Red, or Gold.
- 0-10V dimming option available.
- Lighting controls option available.
- 7 Year Warranty.

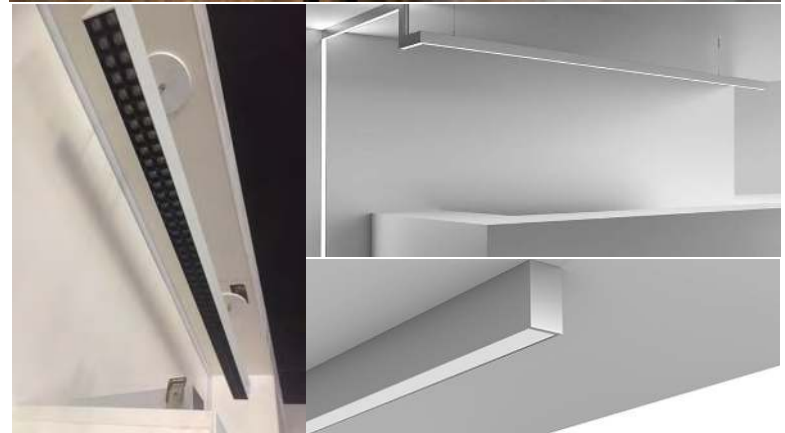

Date:	_____
Project:	_____
Price:	_____

### Dimensions:

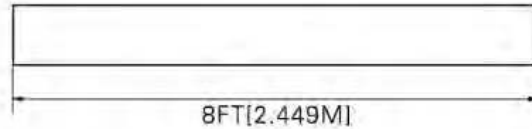
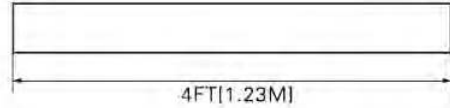
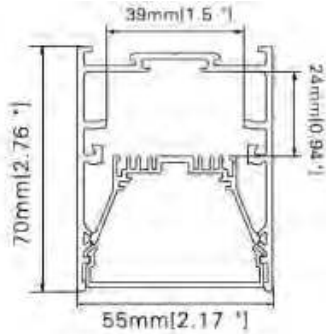

**\* Custom Lengths Available \***

### Installation Accessories:



• Pendant



IL-PTB



IL-PT



IL-PTB-NPF



IL-PTB-PF

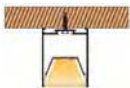

• Ceiling mounted

IL-SM



• Wall mounted



IL457-WM

IL-PTB: pendant wires with canopy

IL-PT :pendant wires without canopy

IL-PTB-NPF: pendant wire+ canopy without cable hole

IL-PTB-PF: pendant wire+ canopy with cable hole

IL-SM: screw for ceiling mounted

IL457-WM, wall mounted clip

### Disassembly Accessories:

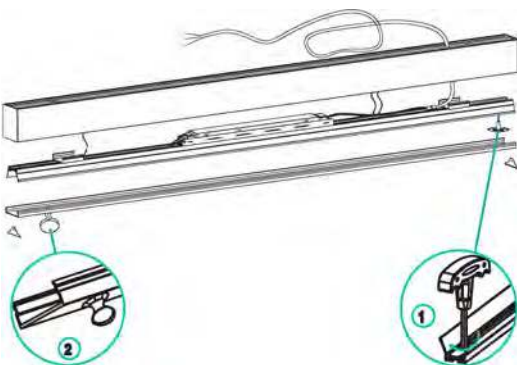

IL-DA-D



IL-DA-A

IL-DA-D: disassembly tool

IL-DA-A: Rubber sucker



Date:	_____
Project:	_____
Price:	_____

## Ordering Key:

SERIES NUMBER	WATTS/ SIZE/ LUMENS	CCT	FINISH	ADDITIONAL OPTIONS
ILLCLBV	21W - 4FT/ 2,100	27 - 2700K	S - SILVER	DM - 0-10V DIMMING
	31W - 4FT/ 3,100	3 - 3000K	WH - WHITE	MS - MOTION SENSOR*
	43W - 8FT/ 4,300	35 - 3500K	BL - BLACK	EM - EMERGENCY BACKUP
	61W - 8FT/ 6,100	4 - 4000K	R - RED	LV - LOUVER
	X - CUSTOM LENGTH	6 - 6000K	GD- GOLD	RO - REFLECTOR OPTIC LENS
				L - LINKABLE

SAMPLE ITEM NUMBER: ILLCLBV 31 4 S DM L

\*PLEASE SEE OUR MOTION SENSOR SHEET ON WEBSITE TO SPECIFY TYPE

## Electrical Data:

- **Input Power:** Stays consistent over life.
- **Input Voltage:** 100-240 VAC
- **CRI:** >90
- **L70 Lifetime:** >50,000 hours.

## Controls:

- This LED fixture is equipped with 0-10V dimming that works universally with any standard 0-10V control or dimmer.

## Photometrics:

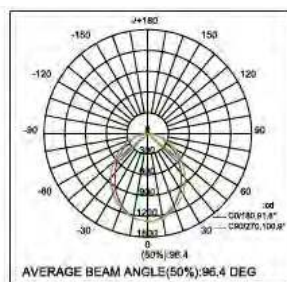
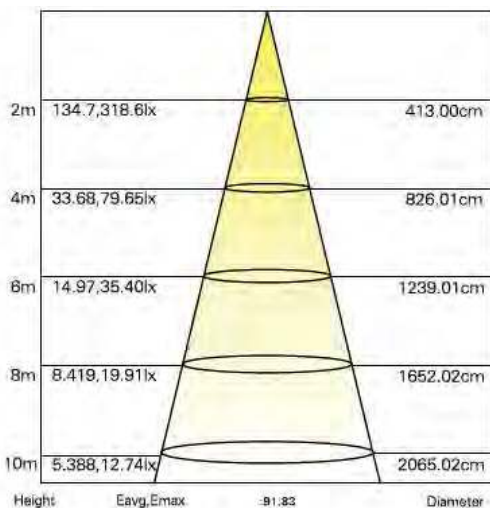

## With Motion Sensor:

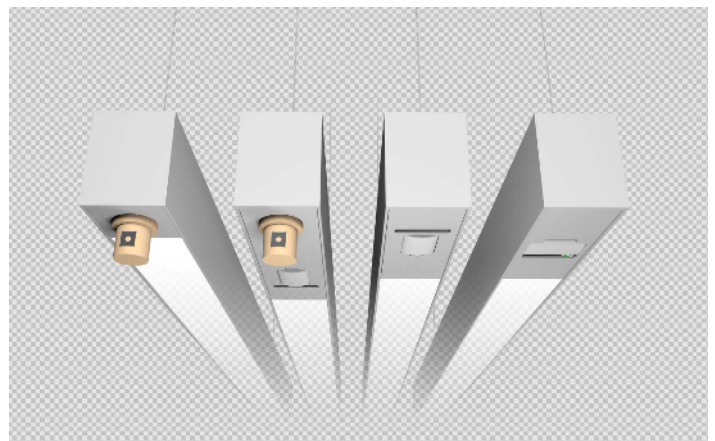

Date:	_____
Project:	_____
Price:	_____

## Connectors:



ITEM NUMBER: LL

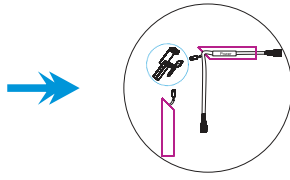

90L sets

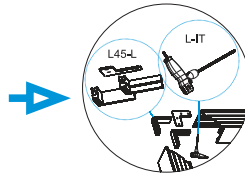

Mechanical connection

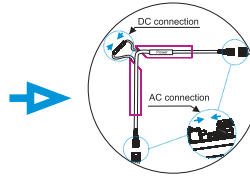

Electrical connection

Dimension: L609.6mm(2ft) \* W609.6mm(2ft)

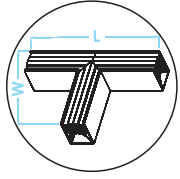

ITEM NUMBER: TC

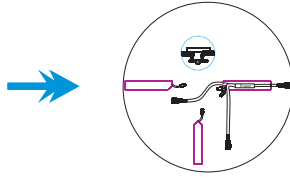

90T sets

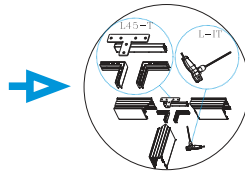

Mechanical connection

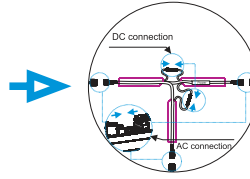

Electrical connection

Dimension: L1219.2mm(4ft) \* W609.6mm(2ft)

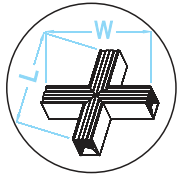

ITEM NUMBER: XC

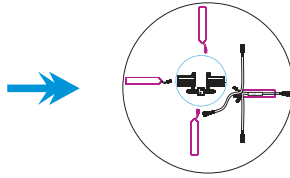

90X sets

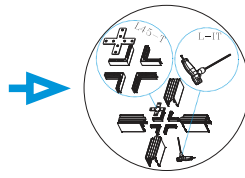

Mechanical connection

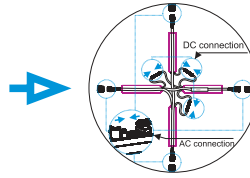

Electrical connection

Dimension: L1219.2mm(4ft) \* W1219.2mm(4ft)

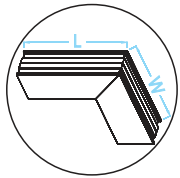

ITEM NUMBER: CC

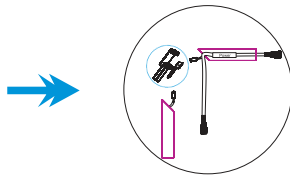

90N sets

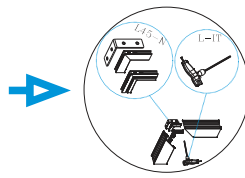

Mechanical connection

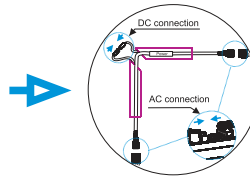

Electrical connection

Dimension: L609.6mm(2ft) \* W609.6mm(2ft)

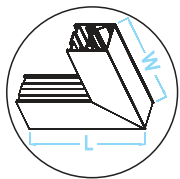

ITEM NUMBER: VC

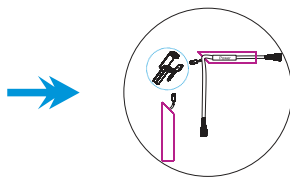

90W sets

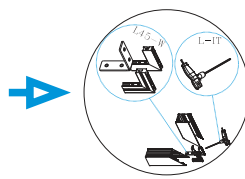

Mechanical connection

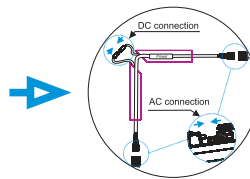

Electrical connection

Dimension: L609.6mm(2ft) \* W609.6mm(2ft)

## Connection Ordering Key:

ILLCLBV

SERIES NUMBER	CONNECTION	ADDITIONAL OPTIONS
ILLCLBV	LL - L SHAPED CONNECTOR	
	TC - T SHAPED CONNECTOR	
	XC - X SHAPED CONNECTOR	
	CC - CORNER SHAPED CONNECTOR	
	VC - V SHAPED CONNECTOR	