

# WALL STREET DOWN LIGHTS

## Description:

Our Wall Street Down lights are perfect for both New Construction and Remodel applications. They are fully dimmable with multiple finish /shape options. Perfect for Indoor locations; retail, offices, & supermarkets.

## Features:

- Input Power: 90-130V
- Power Consumption: 6W, 9W, 12W
- Beam Angle: 110
- CRI >90
- Available Color Options: 3000K, 3500K, 4000K or 5000K
- Finish: White or Black
- Available Shapes: Round or Square
- 1-10V Dimming
- Operating Temperature: -4°F ~ 104°F
- L70 Lifetime: >50,000 hours
- Lighting controls option available.
- 7 Year Warranty

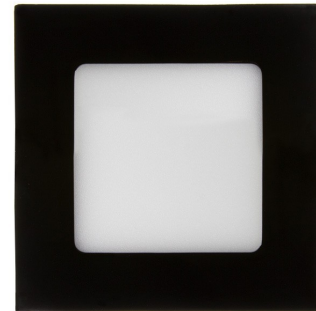

## Dimensions:

### (1)LED Round Down Light

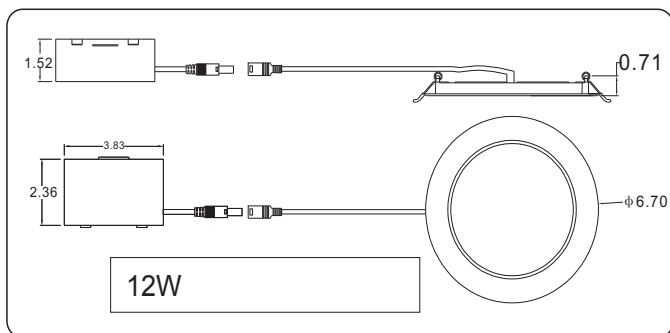
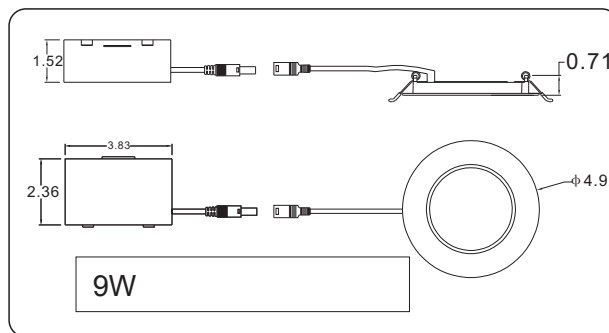
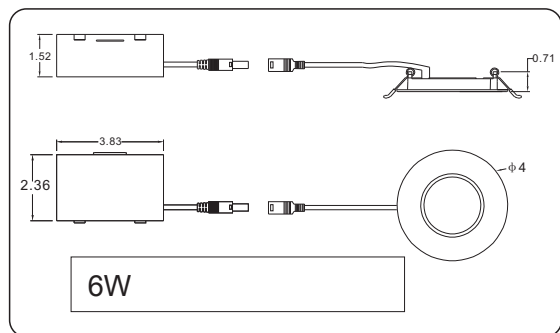

### (2)LED Square Down Light

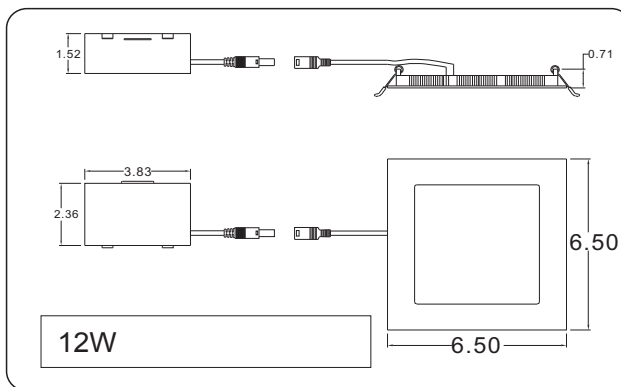
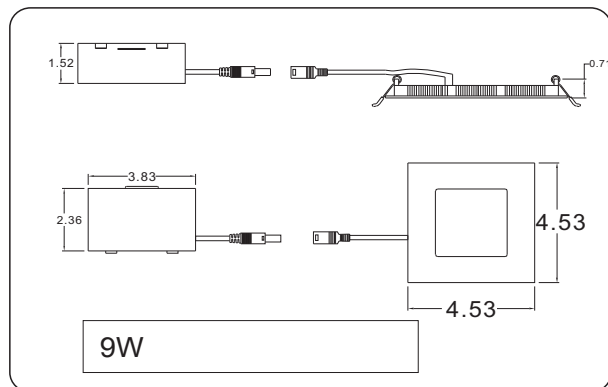

Date: \_\_\_\_\_  
Project: \_\_\_\_\_  
Price: \_\_\_\_\_

### Ordering Key:

ILDLWSSC					
SERIES NUMBER	SHAPE	WATT	CCT	FINISH	ADDITONAL OPTIONS
ILDLWSSC	RD - ROUND	6W - 6W	30 - 3000K	WH - WHITE	DM - 1-10V DIMMING
	SQ - SQUARE	9W - 9W	35 - 3500K	BK - BLACK	
		12W - 12W	40 - 4000K		
			50- 5000K		

SAMPLE ITEM NUMBER: ILDLWSSC SQ 9W 35 BK

### Electrical Data:

- **Input Power:** Stays consistent over life.
- **Input Voltage:** 90-130V
- **CRI:** >90
- **Operating Temperature:** -4°F ~ 104°F
- **L70 Lifetime:** >50,000 hours.

### Controls:

- This LED fixture is equipped with 1-10V dimming that works universally with any standard 0-10V control or dimmer.

### Optical System:

- A unique combination of reflective & refractive optical components achieves a uniform, comfortable look while eliminating pixelation & color fringing.
- Parts work in unison to optimize light distribution, balancing the high delivery of high illuminance levels on horizontal surfaces with an ideal amount of light on walls and vertical surfaces, increasing perception of spaciousness.



## Installation

1. Drill hole according model

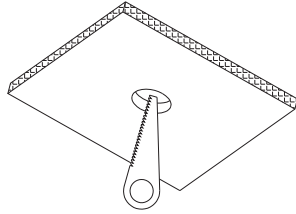

Note :Please check the hole size at model list table

2. (1) Rotate right-handed with slotted screwdriver to remove the top cover  
(2) Open the side knockout of the junction box with slotted screwdriver

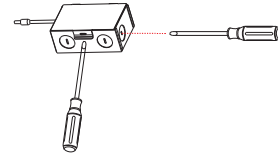

3. Wire connection  
White wire is connected to N; black wire is connected to L; and yellow wire is connected to G

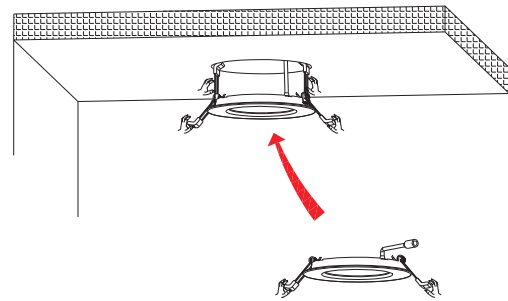
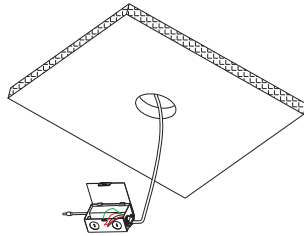

4. Embed the light into the hole of ceiling

## Installation requirements

1. Power off before installation
2. Drill proper hole into the ceiling according to product model
3. Connect AC wire
4. Embed the light into ceiling hole
5. Light up and test; installation finish

