

Date:	_____
Project:	_____
Price:	_____

# RGBW RIBBON LIGHT

## Description:

Our Ribbon Light is available in RGBW+3000K, 4000K or 6000K at 374 Lm/ft. Having an array of lengths to choose from, our Ribbon Light is perfect for coves, accent lighting, under cabinet, back lighting and toe kicks.

## Features:

- Use with I-Luminosity channel profiles to create a custom fixture.
- Flexible.
- 24V input voltage.
- 0-10V dimmable option.
- L70 Lifetime: >50,000 hours.
- 7 year warranty.
- Lighting control options available.
- CRI >90
- Available in RGBW 3000K, 4000K or 6000K.
- Available IP: IP20, IP65 OR IP68.
- Beam Angle: 120°
- Wide variety of lengths.

## Dimensions:

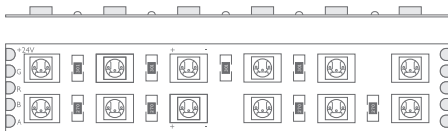

**CUTTABLE EVERY:** 3.94 in.  
**WIDTH IP20+IP65:** 0.80 in.  
**WIDTH IP68:** 0.93 in.



## Applications:

- Commercial
- Entertainment
- Healthcare
- Hospitality
- Museums
- Public Spaces
- Residential
- Retail



COVES



ACCENT LIGHTING



UNDER CABINET

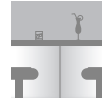

BACK LIGHTING



TOE KICKS



## Color Options:

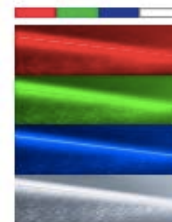

RGBW

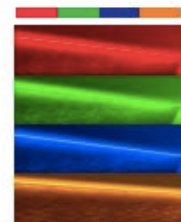

RGBA



Date:	_____
Project:	_____
Price:	_____

### Connection Options:

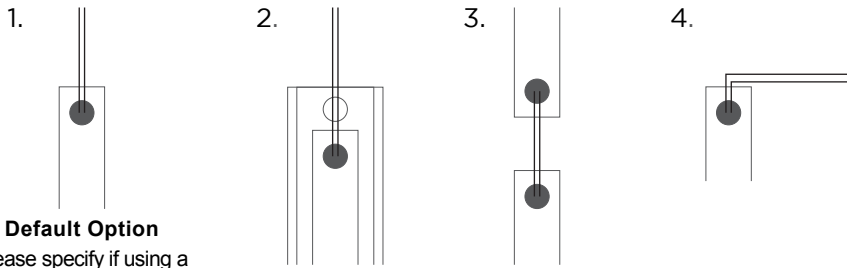

- 1 - End Feed for Hard Wired Connection
- 2 - Back Feed Through Back of Channel
- 3 - Soldered Daisy-Chain
- 4 - Side Feed
- 5 - IP20 Connectors
- 6 - IP68 Connectors

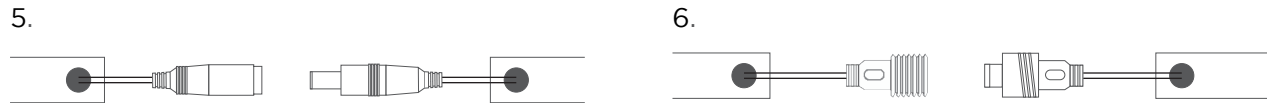

**Default Option**  
Please specify if using a different connector type.

### RGBW + RGBA Ribbon Light Channel Options:

#### Surface Mount Channels:

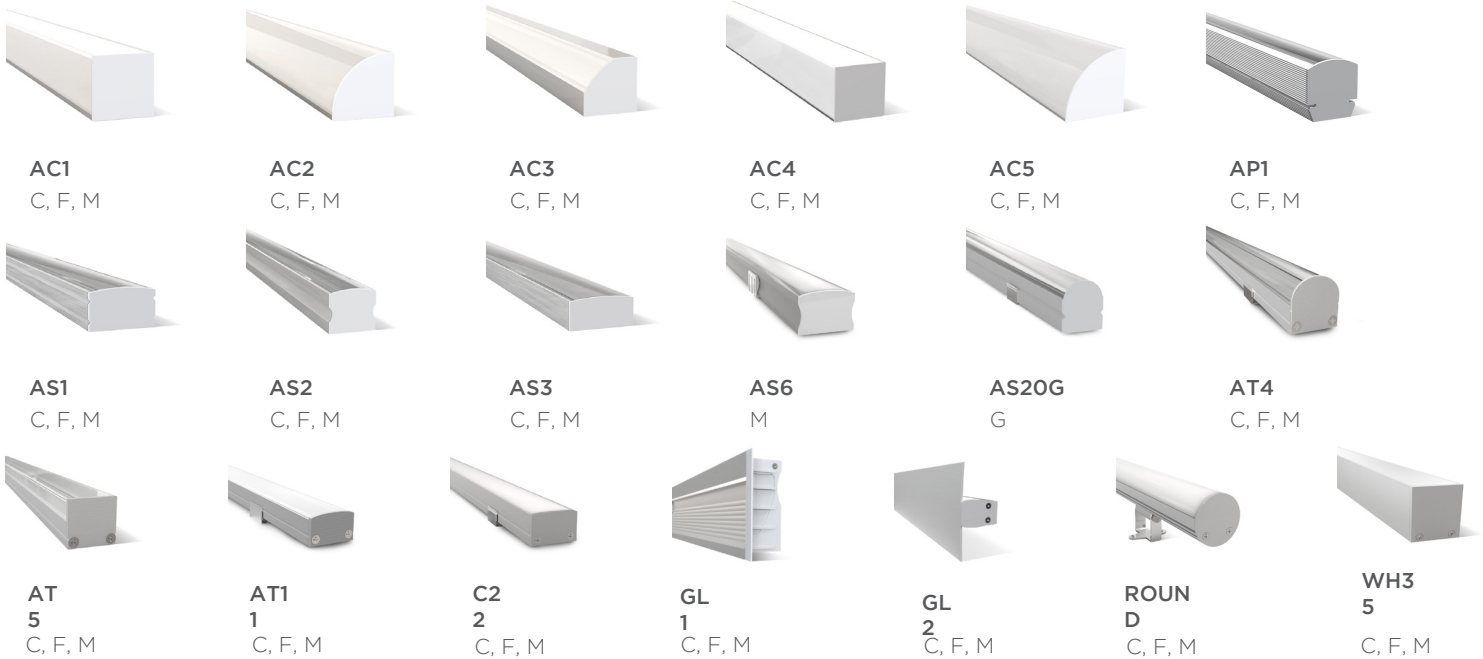

#### Recessed Channels:

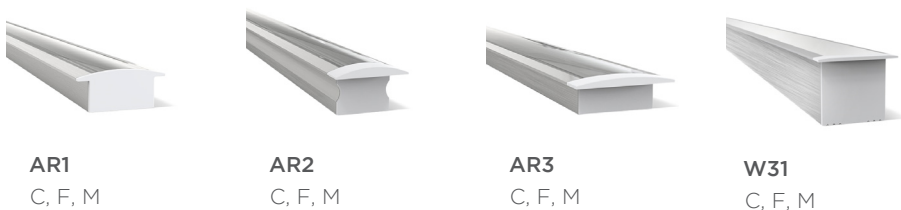

Date:	_____
Project:	_____
Price:	_____

## Ordering Key:

ILDCRLWAC

SERIES NUMBER	WATTS / SIZE / LUMENS	CCT	WATERPROOF	ADDITIONAL OPTIONS
ILDCRLWAC	8.8W - 1FT / 374	3K - RGBW+3000K	IP20- NONE	DIM - 0-10V DIMMING
		4K - RGBW+4000K	IP65	
		6K - RGBW+6000K	IP68	
		RGBA - RGB+AMBER		

SAMPLE ITEM NUMBER: ILDCRLWAC 8.8W 3K IP65 DIM

## Electrical Data:

- **Input power:** Stays consistent over life
- **Operating Voltage:** 24V
- **Operating Temperature:** -40°F ~ 158°F
- **CRI:** >90
- **L70 Lifetime:** >50,000 hours.

## Controls:

- This LED fixture is equipped with a 0-10V dimming driver that works universally with any standard 0-10V control or dimmer.

## Optical System:

- A unique combination of reflective & refractive optical components achieves a uniform, comfortable look, while eliminating pixelation & color fringing.
- Parts work in unison to optimize light distribution, balancing the high delivery of high illuminance levels on horizontal surfaces with an ideal amount of light on walls and vertical surfaces, increasing perception of spaciousness.

## Usage Guidelines:

- When installing this product take into account the surface temperature of the material this product is mounted to. Many building surfaces which are exposed to direct sunlight exceed the 70° C / 158° F maximum that our product is rated for. High risk locations like this should be avoided.
- Our IP65 / IP68 can be used in wet, outdoor locations around swimming pools and spa tubs, but our products are not intended to be submerged in pools and fountains and do not carry UL 676 certification to do so.
- Compatible with a wide variety of control products including the entire line of Lutron dimming systems.
- Due to the nature of the product, Ribbon Light cuttable lengths are generally longer or shorter than the customer requested length. Unless specified, Ribbon Light is factory cut at the shorter cuttable point.