

LED CUSTOM LINEAR LIGHT INSTALLATION INSTRUCTIONS

Connectors

A. — node connector

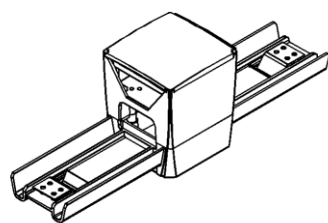

B. L node connector

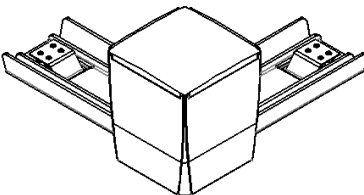

C. T node connector

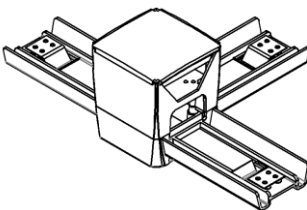

D. X node connector

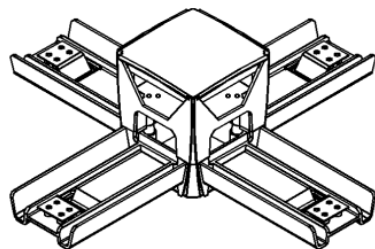

E. Input cable

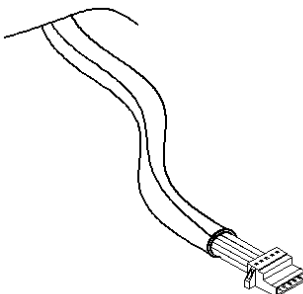

F. End cap.

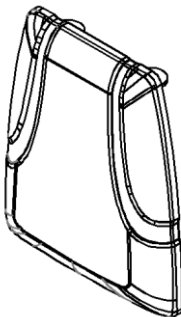

G. Rope

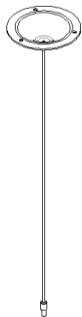

Installation Instruction of Suspended

4.2.1 Take out the fixed base of lifting rope from the accessory bag; place it on the fixed position of the ceiling, and mark it at the fixed position of the screw.

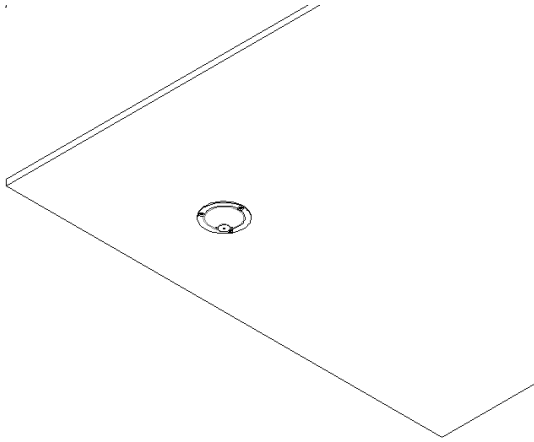

4.2.2 Take out the fixed base of lifting rope from the accessory bag; place it on the fixed position of the ceiling, and mark it at the fixed position of the screw.

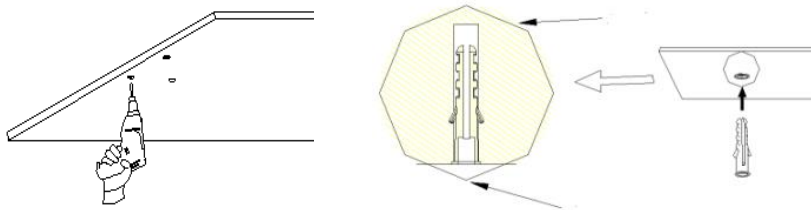

4.2.3 Make sure the “X” is more than 100mm, and the distance between the two fixed base not more than 2000mm.

$X \geq 100\text{MM}$ 。 $B \leq 2000\text{MM}$

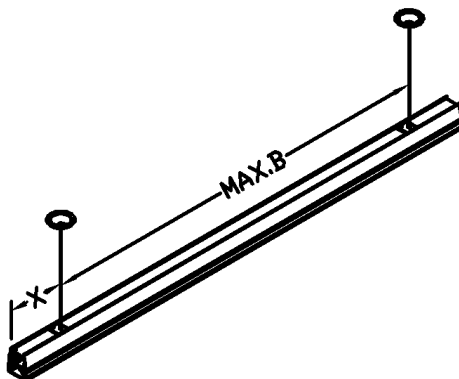

4.2.4 Install the fixed base and lifting rope on the ceiling.

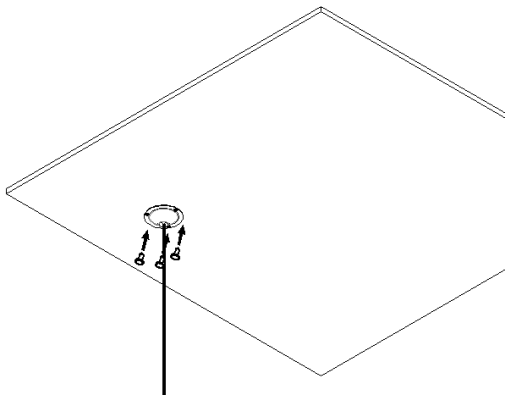

4.2.5 Install the lamp to the rope.

Push the shell card into the top side of the linear light, then adjust the length of the rope and keep it to be horizontal.

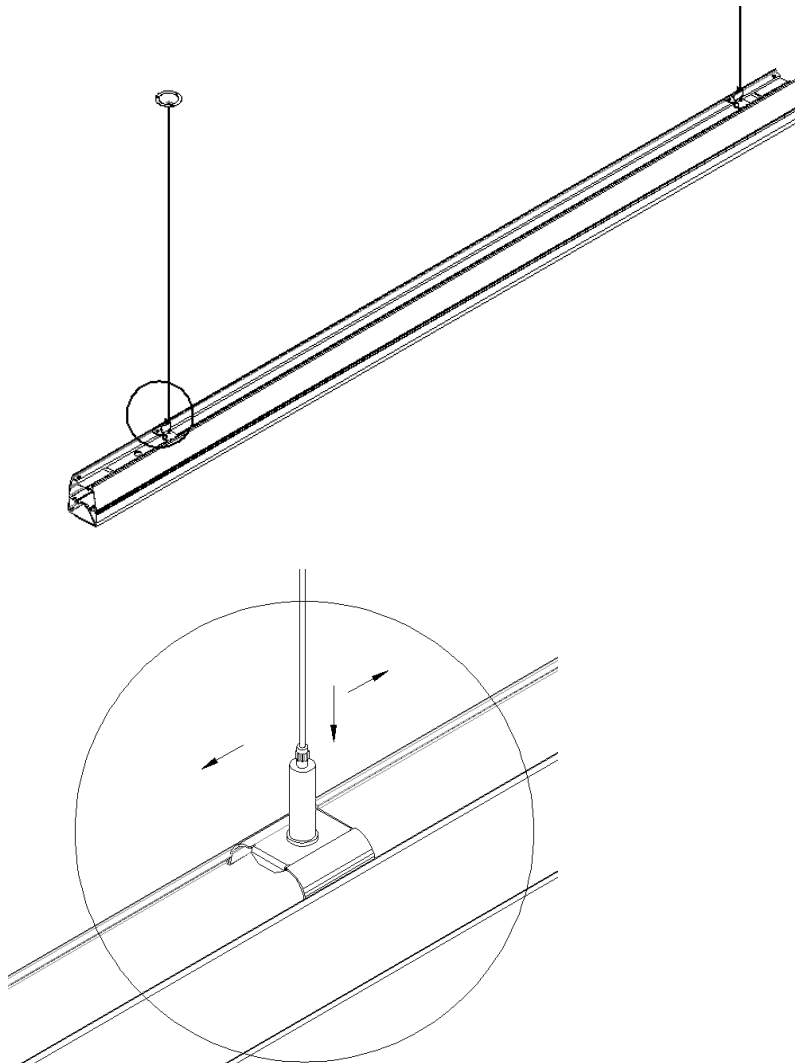

4.2.6

- A. The accessory of the linear light, 5PIN terminal female to match with the accessory of the connector, 5PIN terminal male.
- B. The accessory of the linear light, DC terminal female to match with the accessory of the connector, DC terminal male.
- C. The push the connector into the linear light, then push the second linear light into the holder.

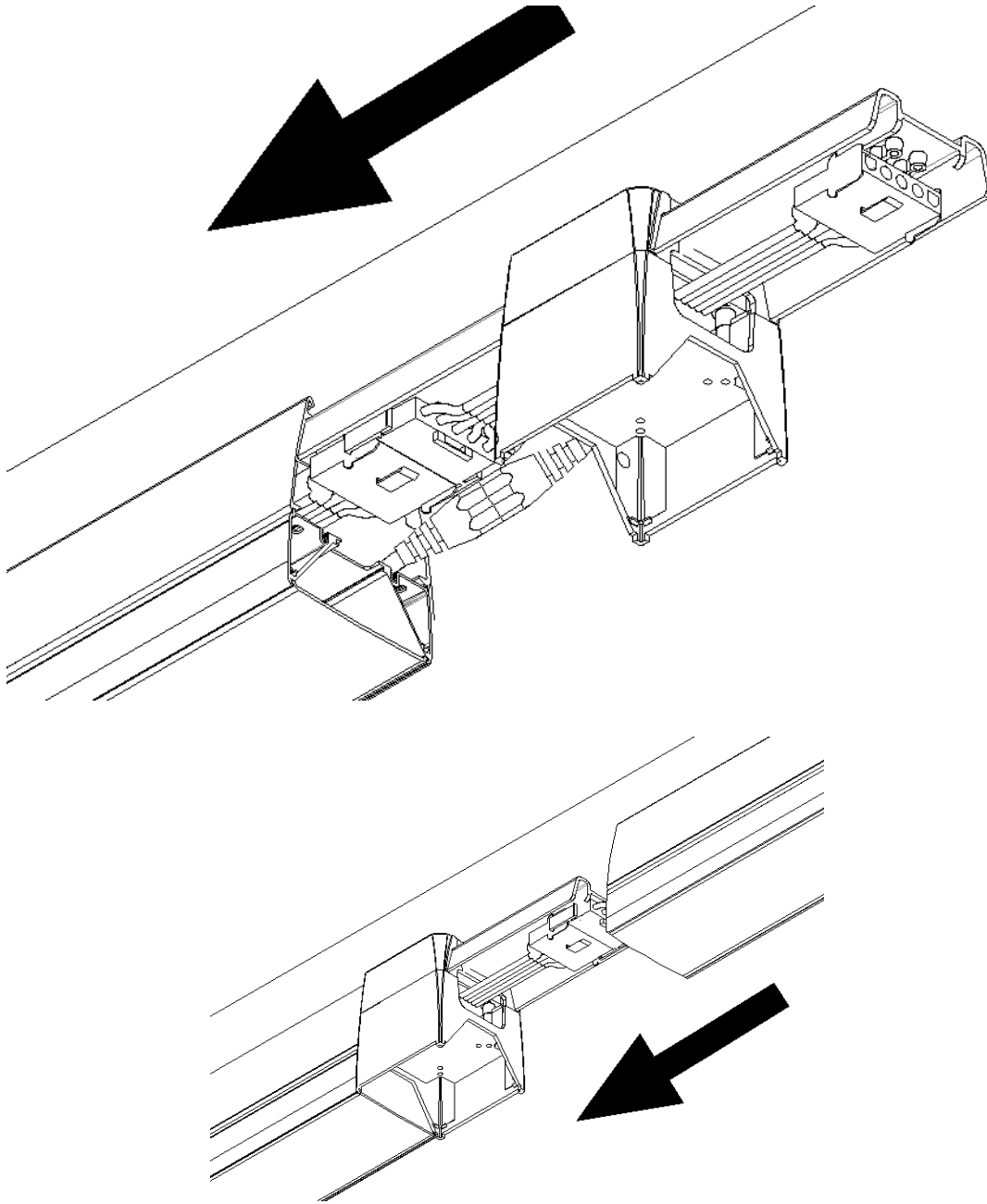

4.2.7 Connect all the linear lights together.

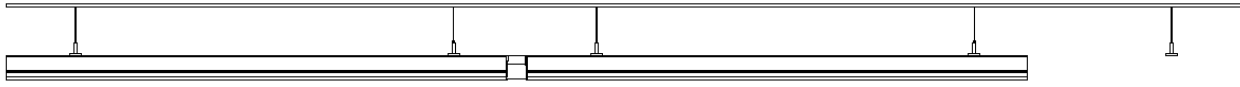

4.2.8 After connecting all the linear lights, put the cover to the connectors, and put the end cap to the two side of the linear light.

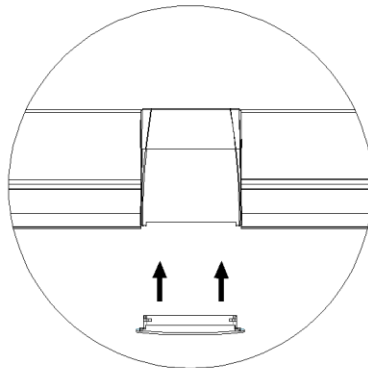
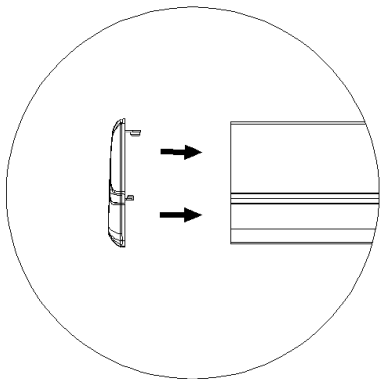
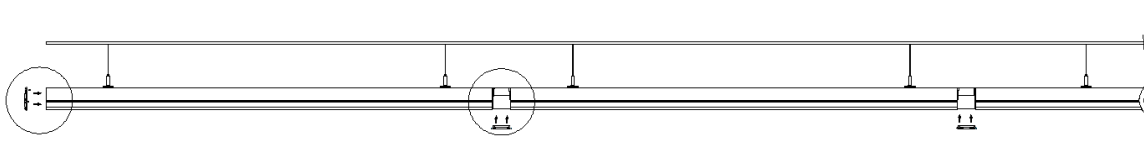

4.3 Installation instruction of the surface mounted.

4.3.1. Drill the hole on the ceiling and install the plastic plug, make sure the holes are in a straight line.

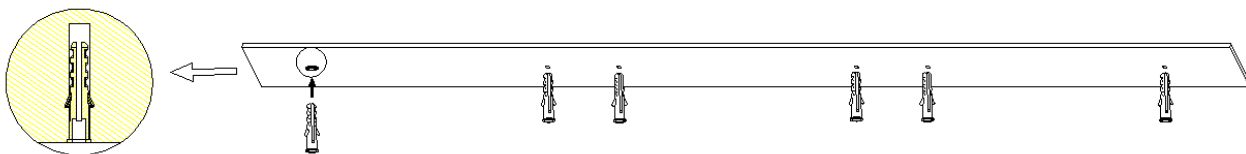

parallel with the installation direction.

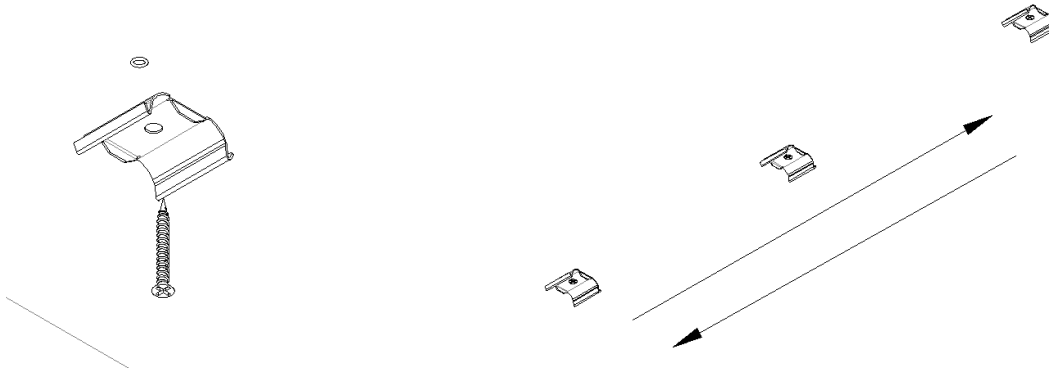

4.3.3. Push the linear light into the shell card.

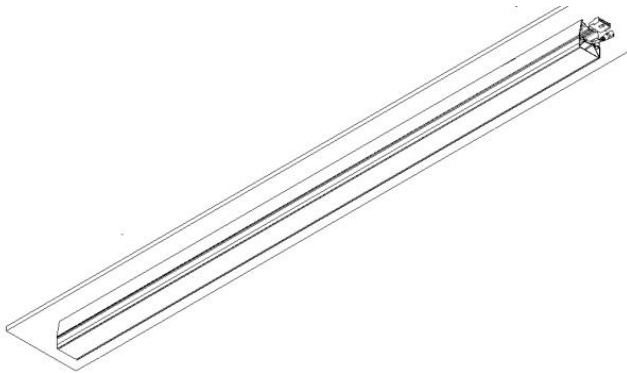

4.3.4 Reference the 5th to 9th Steps of the Suspended