

ANGEL WING LED PENDANT LIGHT



Features

- Elegant design allows for a nearly transparent luminaire when off and excellent uniformity and efficiency when on
- High quality Mitsubishi LGP never turn yellow within 5 years
- Easy to install, labor-saving
- Pure aluminum keeps good heat dissipation
- The two wings' angle are adjustable to make different light distribution
- ETL certificated



WATERFALL LED PENDANT LIGHT

| ITEM # | SIZE | LENGTH (MM) | VOLTAGE | WATT | LUMEN OUTPUT | CRI | WEIGHT |
|------------------|------|-----------------|---------------|------|--------------|-----|--------|
| SWWGMPJD12395W50 | 4FT | 1200 x 395 x 95 | AC 110 / 277V | 40W | 4,000 | >90 | 5 KG |



1. Installation tools

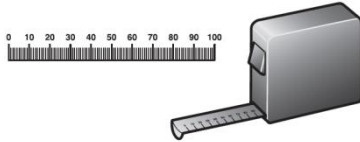

Measuring Tape

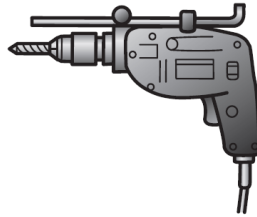

Hand drill (8MM drill bit)

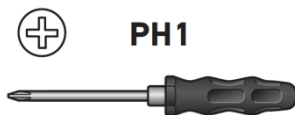

Screw driver PH1



Stripping piers

2. Installation procedures:

1) Check the BOM before installation.

| | |
|-------------------------------------|------|
| Lamp body | 1PCS |
| Accessory box | 1PCS |
| Hanging rope (in accessories box) | 2PCS |
| Screw 4.5*40MM (in accessories box) | 2PCS |
| Canopy (in accessories box) | 1PCS |
| Bracket (in accessories box) | 1PCS |
| Screws M4*25MM (in accessories box) | 2PCS |
| Rubber plug (in accessories box) | 2PCS |
| Cable tie (in accessories box) | 2PCS |

2) Install the hanging ropes.

Step 1, Lock the bracket to the junction box. As picture (1). Screw one end of the hanging rope into the middle of this bracket. As below picture (2).

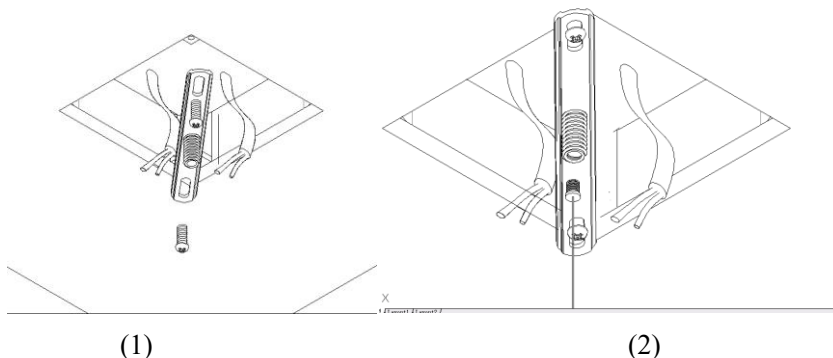

Dimension of the bracket: L155*W17.77*H5.89mm

Step 2, Confirm the other hanging rope's position according to the distance from the fixed rope.
References of distance between the two ropes are as chart below.

| | |
|-----------------------|------------------------|
| GM-PJD12395W50 (1.2M) | $A \leq 1100\text{MM}$ |
|-----------------------|------------------------|

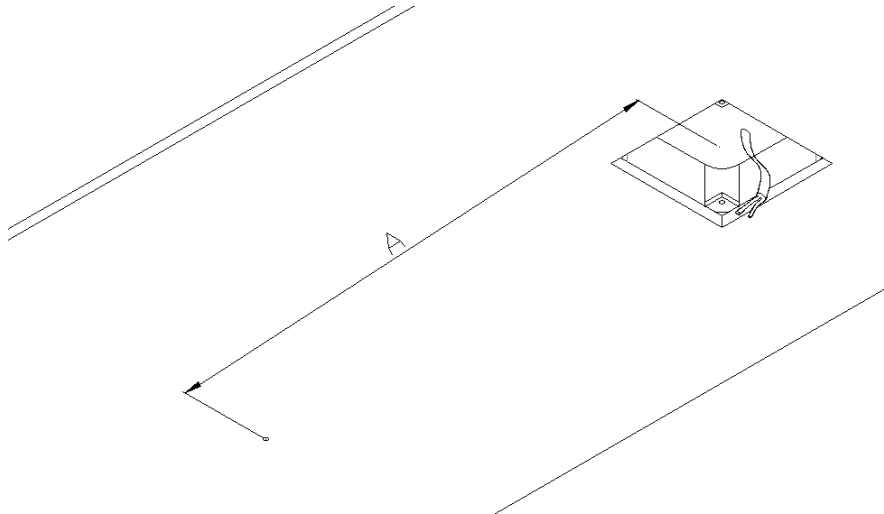

Step 3, Mark up the position and drill an 8MM hole. Put the rubber plug into the hole.

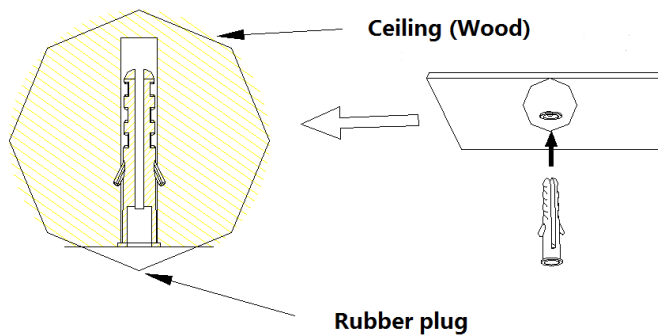

Step 4, Lock the screw stand to the hole as picture (3). Screw one end of the hanging rope into the screw stand as picture (4).

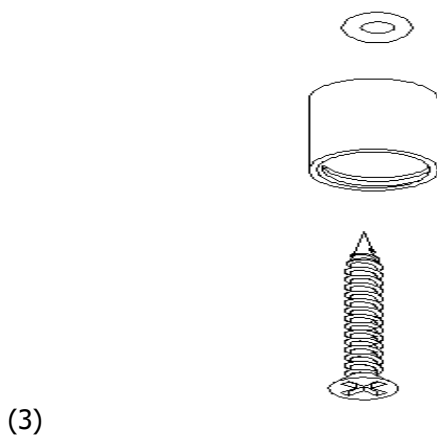

3) Hang up the lamp body

Lift the lamp body, screw the other end of the hanging rope into the back hole of lamp as picture below:

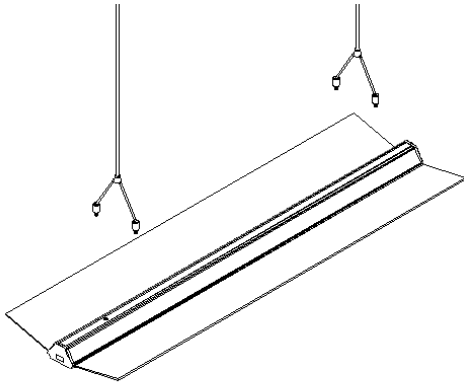

4) Connect the wires

Step 1, Adjust the height of lamp then put the power cord through the canopy to the junction box as picture below. Connect the the power cord with wires in the junction box: L to L (white), N to N (black), DIM+ to DIM+ (red), DIM- to DIM- (yellow):

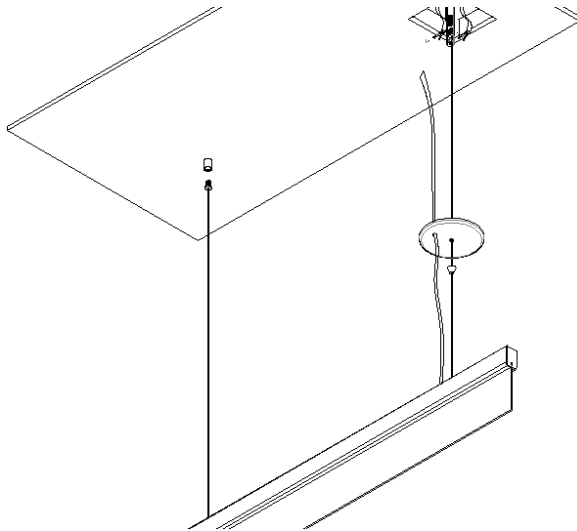

Step 2, Lock the canopy with the junction box as picture below:

Dimension of the canopy: $\Phi 160 \times 20\text{mm}$

