

## Advantages

- Energy saving up to 50% compared with traditional fluorescent under the same flux
- Life Span—over 50,000 hours
- Available in cool white, neutral white, and warm white color temperatures;
- Standard length: L1=300MM, L2=500MM and L3=1000MM, and customized length is also available. Standard finish color: white or silver, and customized color is also available.
- **Easy linking up to 48 watts per run and up to 3 meters when connected in series.**
- Easy installation with only 2 screws.
- The direction of LED light can be adjusted for 0° ,45° and 90° .
- Low voltage, more safety.
- Warranty: 7 years.

## Applications

LED show case lighting; LED shelf lighting; LED retail product Lighting; LED Furniture Lighting; LED bookcase lighting; LED wardrobe lighting; LED wine cabinet lighting; LED under cabinet lighting; LED kitchen cabinet lighting; LED cove lighting; LED accent lighting; LED task lighting; LED product line lighting

## Technical Operating Data (Clear lens)

Model No.	length	Number of leds	Voltage	Power	Radiance	Color Temp.	CRI	Luminous Flux
	[mm]	[pcs]	[Vdc]	[W]	Angle [°]	[K]		[lm]*
ILUCULC106"	L=150	21	24	2.5	120	2700-6500k	>80	250
ILUCULC108"	L=203	28	24	3	120	2700-6500k	>80	300
ILUCULC1012	L=300	49	24	5	120	2700-6500k	>80	500
ILUCULC1016	L=406	63	24	6.5	120	2700-6500k	>80	650
ILUCULC1020"	L=500	77	24	8	120	2700-6500k	>80	800
ILUCULC1022'	L=560	84	24	9	120	2700-6500k	>80	900
ILUCULC1024'	L=610	98	24	10	120	2700-6500k	>80	1000
ILUCULC1032"	L=813	126	24	13	120	2700-6500k	>80	1300
ILUCULC1040'	L=1000	154	24	15	120	2700-6500k	>80	1500

## Technical Operating Data (frosted lens)

Model No.	length	Number of leds	Voltage	Power	Radiance	Color Temp.	CRI	Luminous Flux
	[mm]	[pcs]	[Vdc]	[W]	Angle [°]	[K]		[lm]*
ILUCULC106"	L=150	21	24	2.5	120	2700-6500k	>80	210
ILUCULC108"	L=203	28	24	3	120	2700-6500k	>80	250
ILUCULC1012	L=300	49	24	5	120	2700-6500k	>80	420
ILUCULC1016'	L=406	63	24	6.5	120	2700-6500k	>80	550
ILUCULC1020"	L=500	77	24	8	120	2700-6500k	>80	680
ILUCULC1022'	L=560	84	24	9	120	2700-6500k	>80	760
ILUCULC1024'	L=610	98	24	10	120	2700-6500k	>80	850
ILUCULC1032"	L=813	126	24	13	120	2700-6500k	>80	1100
ILUCULC1040'	L=1000	154	24	15	120	2700-6500k	>80	1200

Dimensions: 33mm (width) x 9.5mm (height) x "L"

Materials: Aluminum extrusion with plastic end caps, Acrylic Lens

Light Source: High brightness SMD3014 LED

Operating Temperature: -20°C to 40°C - Indoors

Installation: 2 M3x10 screws make it easy to install

## Usage Instruction

### 1. Standard package

Standard package includes:

1 piece of LED light, 1 piece of connecting cable, 1 piece of straight connector, 2pcs of screws

ILUCULC10 LINEAR LED LAMP (1 piece)



PC0 STRAIGHT CONNECTOR (1 piece)



M3x10 screws



CC0 CONNECTING CABLE



### LED light (1 piece) :

C10: Basic model number, can connect with various accessories to get many extended functions.

MSW: With built-in on-off switch. Switch function: master switch or individual switch to control itself

DIM: With built-in touch dimmer. By touching this icon  it can not only be dimmable with the lamp gradually brighter or darker but also have on/off switch function.

**Screws (2PCS):** M3.0X10

**Straight connector (1 piece):** can be used for direct connection of LED fixtures.

**Connecting cable (1 piece):** 1 meter long, can be used for long distance connection of LED fixtures.

Date:	_____
Project:	_____
Price:	_____

**2. Basic Usage: The LED light needs to connect with power supply directly.**

The LED light needs to plug into power supply and then it can work, please refer to the picture as below.



**3. Using straight connector and connecting cable to connect the LED lights.**

Based on the above usage, using straight connector and connecting cable can make LED lights interconnection, please refer to the picture as below.



**Note:** The maximum length for connection is not over than 3 meters.

**4. Adjust the direction of LED light**

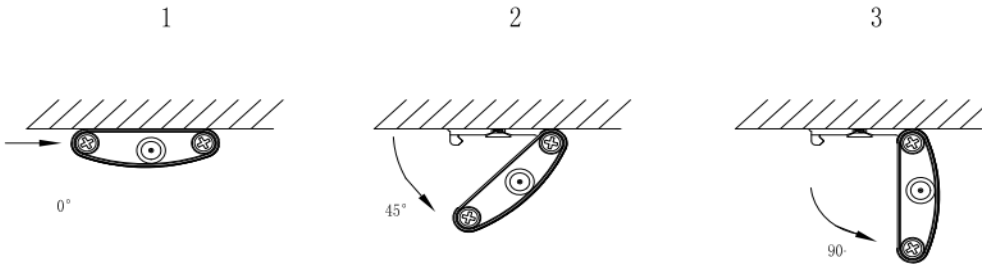

The direction of LED light can be adjusted to 0°, 45° and 90°.

**Installation of LED lights**

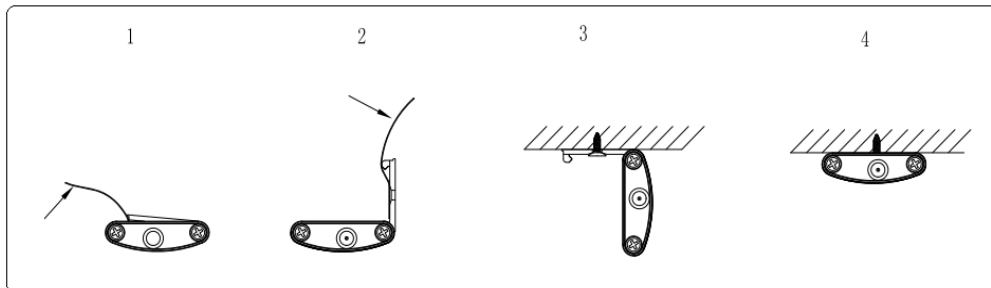

1. Pull up the blue adhesive tape.
2. The adhesive tape will take mounting plate rotate to 90°.
3. Rip the tape and fix the mounting plate with M3\*10 screws onto the place where the LED light needs to be installed.

## Power supply usage instruction

The following table shows how many lamps the power supply can drive respectively. You can select suitable power supply according to the power per run.

Power Supply	6"	8"	12"	16"	20"	24"	32"	40"
6W	2	2	1	XX	XX	XX	XX	XX
12W	4	4	2	1	1	1	XX	XX
24W	9	8	4	3	3	2	1	1
36W	14	12	7	5	4	3	2	2

### Remarks:

1. The standard package of LED light doesn't include power supply, but we can offer the power supply in separated package in different models for your choice.
2. The power of power supply must be over the total power of connected LED lights in series.
3. The voltage of constant-voltage power supply must be same as the voltage of LED lights. The output voltage of power supply can't be allowed to be higher than the input voltage of LED light. If you choose to use other power supply, the power supply must have short circuit protection, overload protection, overheat protection besides the above requirements.

## Packing Information

Product	Color box* size	Carton size	Units/ carton	Net weight [Kg]	Gross weight [Kg]
ILUCULC10 6"	150X36X12	170(length) X120 (width) X230 (height)	40	3	4
ILUCULC10 8"	205X36X12	220(length) X120 (width) X230 (height)	40	3.5	4.5
ILUCULC10 12"	300X36X12	320(length) X120 (width) X230 (height)	40	6.5	7.5
ILUCULC10 16"	410X36X12	430(length) X120 (width) X230 (height)	40	7	8
ILUCULC10 20"	500X36X12	520(length) X120 (width) X230 (height)	40	8	8.5
ILUCULC10 22"	560X36X12	580(length) X120 (width) X230 (height)	40	8.5	9
ILUCULC10 24"	610X36X12	630(length) X120 (width) X230 (height)	40	9	9.5
ILUCULC10 32"	815X36X12	835(length) X120 (width) X230 (height)	40	14	15
ILUCULC10 36"	1000X36X12	1120(length) X120 (width) X230 (height)	40	17	18
Power supply(6w)	76X61X46	250(length) X170 (width) X270 (height)	40	2.5	3.0
Power supply(12w)	136x58x77	315(length) X290 (width) X340 (height)	40	8.4	8.9
Power supply(24w)	136x58x77	315(length) X290 (width) X340 (height)	40	10.0	10.5
Power supply (36w)	136x58x77	315(length) X290 (width) X340 (height)	40	10.0	10.5
PC0 connector	76X61X46	250(length) X170 (width) X270 (height)	360	2.5	3
CC0 cable	76X61X46	250(length) X170 (width) X270 (height)	120	2	2.5

Date:	_____
Project:	_____
Price:	_____

MSW Master switch	76X61X46	250(length) X170 (width) X270 (height)	240	2.5	3
TDM Touch dimmer	76X61X46	250(length) X170 (width) X270 (height)	240	4	4.5
DJB DC Junction box	76X61X46	250(length) X170 (width) X270 (height)	240	2.7	3.2
PIR PIR Sensor	76X61X46	250(length) X170 (width) X270 (height)	120	2	2.5
WSP 4-way splitter	76X61X46	250(length) X170 (width) X270 (height)	120	2.5	3
WSP 8-way splitter	76X61X46	250(length) X170 (width) X270 (height)	120	3.2	3.7
DIM dimmer	76X61X46	250(length) X170 (width) X270 (height)	60	2.2	2.7

## ILUCULC10 Extended accessories

Except the standard accessories, we also can offer optional extended accessories of ILUCULC10 system for your choice to get more various functions. For example: connection, sensor, dimmer and switch, etc.

**MSW: IN-LINE SWITCH**



**TDM: IN-LINE TOUCH DIMMER**



**DJB: DC JUNCTION BOX**



**DIM: WIRED DIMMER**



**PIR: PIR SENSOR**



**MSS: IN-LINE MOVING SENSOR**



### WSP 4/8 WAY SPLITTER

#### Installation instructions of extended accessories

##### 1. In-line switch

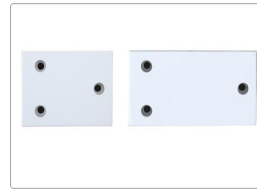

**Installation Instruction:** Use In-line switch to connect with LED lights, then connect the power supply to the input side of the In-line switch.

**Operation:** Press the switch on the body to turn ON/OFF the system at any time and can control all the connected LED lights in a series.

##### 2. TDM In-line Touch Dimmer: with dimmer and switch function



#### Installation Instructions:

1. Use In-line Touch Dimmer to plug into the DC jack socket and secure the Dimmer to the mounting surface.
2. Connect the power supply to the input side of the Dimmer.

#### Operation:

1. Touch the power icon [⏻] on the body to turn ON/OFF the system at any time.
2. The initial brightness is fixed at 100% when the system is first powered up.
3. When the light is on, the brightness can be adjusted by touching and holding the power icon for more than 0.5 seconds.
4. If the power to the dimmer is uninterrupted, the light level will be memorized when the system is turned off and then on again.
5. The dimmer switch can control all the connected LED lights in a series.

**Note:** This touch switch can't control LED lights with built-in dimmer. If control the whole series in one line, please connect the LED lights without dimmer function.

##### 3. DJB DC Junction box

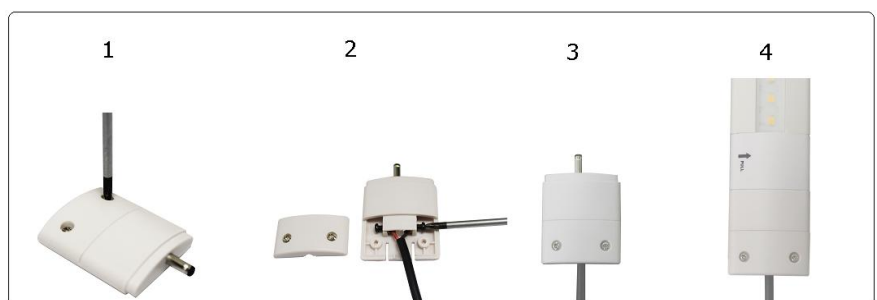

If use the power supply without DC plug or need to cut off the DC plug of power supply to connect LED light, you can choose to use DC junction box to connect the LED light with hardwired power supply.

**Installation instructions:**

1. Open the cover of DC junction box with screw driver.
2. Insert the positive and negative output side of power supply into the positive and negative terminal block and lock the screws of terminal block.
3. Close the cover by fastening the screws.
4. Plug the DC junction box into the DC jack socket and secure the DC junction box to the mounting surface.
5. Connect the power supply to the input side of the DC junction box.

**Note:** The LED light will not work if the positive & negative output side between power supply and terminal block is not consistent. It will not destroy LED light and you can make the correct positive & negative connection between them.

**4. DIM: Wired Dimmer: with dimmable and switch function**



**Installation Instructions:**

1. Use the screws provided to secure the Dimmer to the mounting surface.
2. Connect the output to the LED light
3. Connect the power supply to the input side of the Dimmer.
4. This dimmer can be used in the place where the distance is less than 1 meter from the LED light

**Operation:**

1. Touch the power icon [🔌] on the body to turn ON/OFF the system at any time.
2. The initial brightness is fixed at 100% when the system is first powered up.
3. When the light is on, the brightness can be adjusted by touching and holding the power icon for more than 0.5 seconds.
4. If the power to the dimmer is uninterrupted, the light level will be remembered when the system is turned off and then on again.
5. The dimmer switch can control all the connected LED lights in a series.

**Note:** This touch switch can't control LED lights with built-in dimmer. If control the whole series in one line, please connect the LED lights without dimmer function.

**5. Moving Sensor MSS: With automatic sensor function.**





**Installation Instructions:**

1. Use the sensor to plug into the DC jack socket and secure the Sensor to the mounting surface.
2. Connect the power supply to the input side of the Sensor.

**Basic Data:**

Detection Distance: 3m

Detection Range: 120°

Installation Angle: 0°, 45°, 90°

Delay time: Standard is 30 seconds and can be adjusted to 2 minutes (can design in 1s ~20 minutes as customers' request)

**Functional information:**

1. Automatic detection: when people enter the detection area, infrared ray detector will output 12V or 24V and the light turns on.
2. Delay function: when people leave the detection area or people stay still, the light will turn off after 30 seconds. Delay time can be adjustable from 30 seconds to 3 minutes, or others.
3. Continuous detection: when people have activities during the period of delay time, the detector works and the light is always on.
4. Installation Angle: The sensor can be easily rotated and made 0 degrees or 45 degrees or 90 degrees with the mounting surface of light..

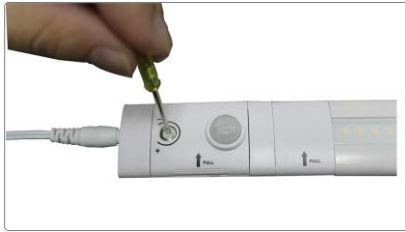

5. PIR: PIR SENSOR is especially designed for ILUCULC10 series LED light, use for other product maybe can't work normally.

**6. PIR Sensor PIR: With automatic sensor function.**



**Installation Instructions:**

1. Use the screws provided to secure the Sensor to the mounting surface.
2. Connect the output to the LED light
3. Connect the power supply to the input side of the Sensor.
4. This dimmer can be used in the place where the distance is less than 1 meter from the LED light.

**Technical Features:**

Dimensions:  $\varnothing$  48mm X 12mm

Installation: Use 2 M3.0x10 screws

Input/ Output voltage : DC12V or DC24V

Related load wattage: Max 24W in 12V or 36W in 24V

Detection Distance: 2m

Detection Range: 120°



Delay time: Standard is 30 seconds (can design in 1s ~20 minutes as customers' request)  
Ambient light: <10 lux daylight .

**Drawing:**

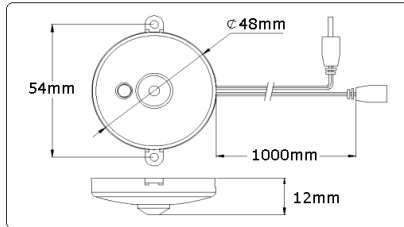

**Installation information:**

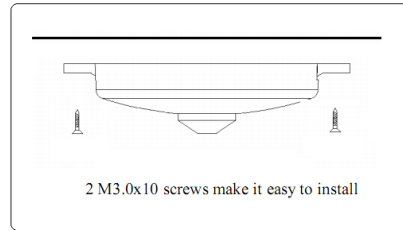

**Functional information:**

1. Automatic detection: when people enter the active zone, infrared ray detector will output 12V or 24V and the light turns on.
2. Delay function: when people leave the active zone or people stay still, the light will turn off after 30 seconds.
3. Continuous detection: when people have activities during the period of delay time, the detector works and the light is always on.
4. Light sensitive control: The PIR Motion Sensor has two sensitive parts, one is infrared ray sensitive part, and the other is light sensitive parts. So it works when people enter in the active zone in the daylight luminance is less than 10 lux.

**7. WSP4/8 WAYSPLITTER.**

You can use WSP 4/8 WAYSPLITTER when one power supply needs to driver many pieces of LED LIGHTS.

