

LED Sleek Linear Fixture SWWWL Series Installation Instructions

Installation method

- Carefully unpack unit and properly inspect for defects before installing. Wear work gloves to prevent dirt and oil from being transferred to the luminaires.
- Properly inspect for accessories whether complete before installing.

Installation tools

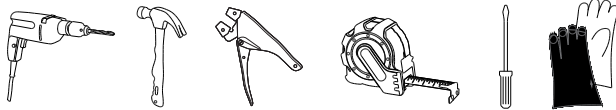

Suspended type subassemblies

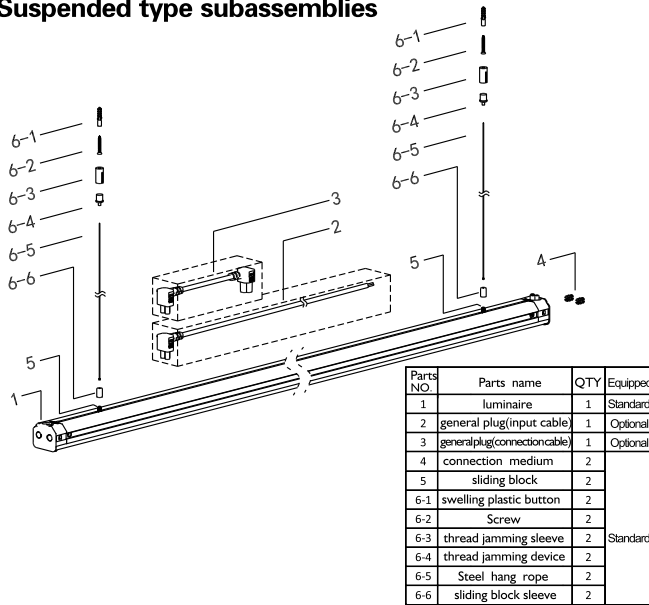

Surface mounted subassemblies

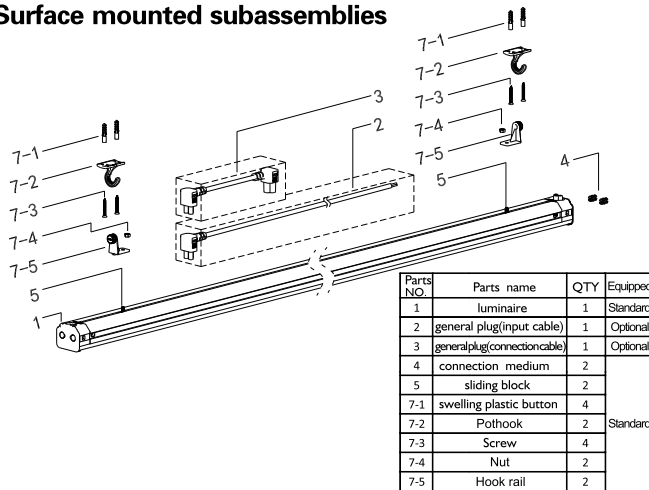

Suspended type

Recommend installing distance

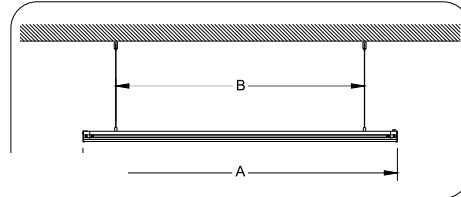

	Dimension A	Dimension B
	300mm	150mm
	450mm	300mm
	600mm	450mm
	900mm	750mm
	1200mm	1050mm
DG06F	1500mm	1350mm

Accessories installation

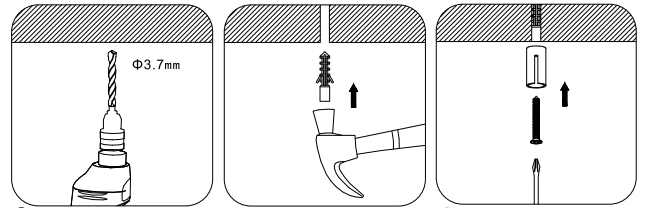

1 Digging a hole on the right place which follows the design.

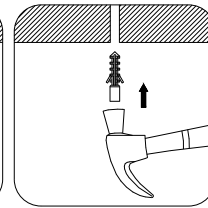

2 Nailing the accessories 6-1 (swelling plastic button) into the hole.

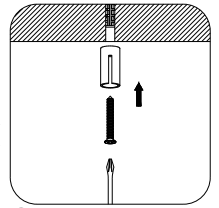

3 Tight accessory 6-3 (thread jamming sleeve) by using accessory 6-2 (Screw).

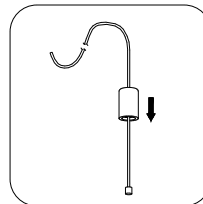

4 Get the accessory 6-5 (Pendant steel wire) across accessory 6-6 (sliding block sleeve).

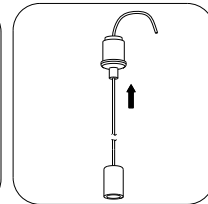

5 Get the other end of the Pendant steel wire into accessory 6-4 (thread jamming device).

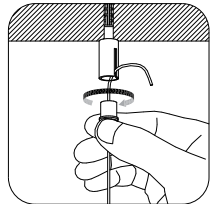

6 Fixed the accessories by thread jamming in the 6-3 sleeve.

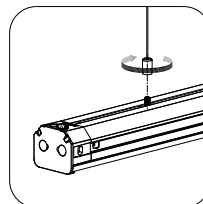

7 Adjust accessory 5 (sliding block) to the right place, then get it connected tightly with accessory 1-6 on the pendant wire.

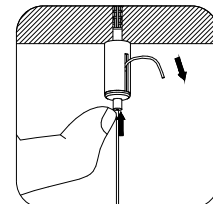

8 If the height needs to be re-adjusted, please hold and pull the spring pin of accessory 6-4 (thread jamming device) meanwhile pull the pendant steel wire.

Electrical connection

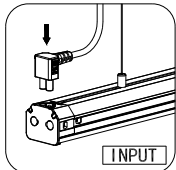

Connect the accessory 2 (input cable).

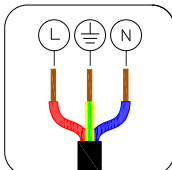

UL Wires: White(L wire)/Black(N wire)/Green(Earth wire)
IEC Wires: Red(L wire)/Blue(N wire)/Olive(Earth wire)
Follow all NEC and local codes to make wiring!

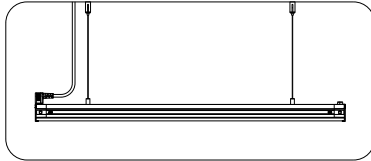

Single luminaire installation completed.

Strip-type connection

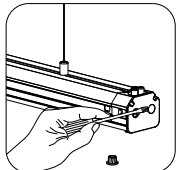

1 Take out dustproof plug from the connecting end face;

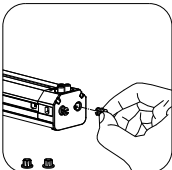

2 Encased 2pcs accessory 4 connecting washers ;

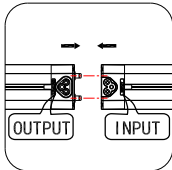

3 Properly connecting the luminaire , Carefully connecting form by INPUT and OUTPUT;

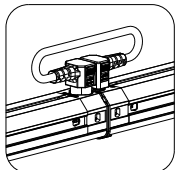

4 Connecting the accessory 3 (connection cable).

T shape connection form

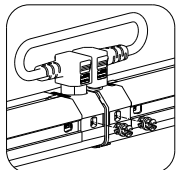

1 Connector side face encase 2pcs accessory 4 connecting washers;

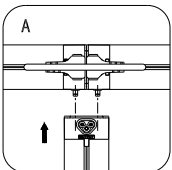

2 T shape is connected by A or B form.

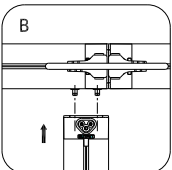

L shape connection form

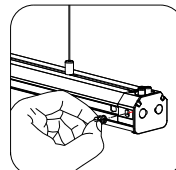

1 Connector side face encase 1pcs accessory 4 connecting washer ;

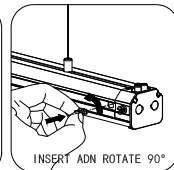

2 Insert the accessory 4 connecting washers into heat sink and rotate 90 degrees ;

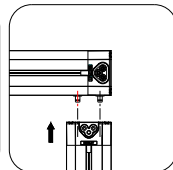

3 Properly connecting the luminaire , Carefully connecting form by INPUT and OUTPUT;

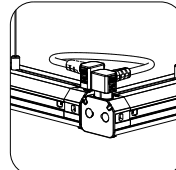

4 Connecting the accessory 3 (connection cable).

More connecting

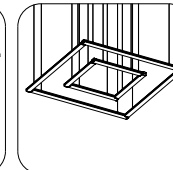
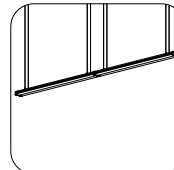
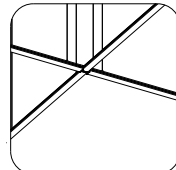

* Maximum power of Each group luminaires is 500W.

Surface mounted (Wall mounted/Ceiling type)

Recommend installing distance

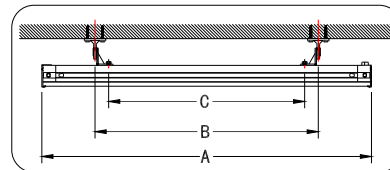

Dimension A	Dimension B	Dimension C
300mm	100mm	49mm
450mm	250mm	199mm
600mm	400mm	349mm
900mm	400mm	649mm
1200mm	1000mm	949mm
1500mm	1300mm	1249mm

Luminaire installation

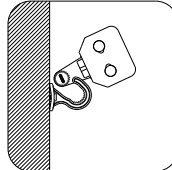

1 Put the hook rail into pothook ;

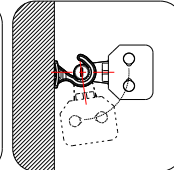

2 Luminaire rotatable 0°~82° beam angle.

Electrical connection

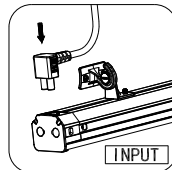

Connect the accessory 2 (input cable).

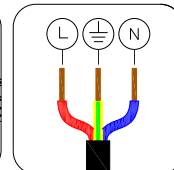

UL Wires: White(L wire)/Black(N wire)/Green(Earth wire)
IEC Wires: Red(L wire)/Blue(N wire)/Olive(Earth wire)
Follow all NEC and local codes to make wiring.

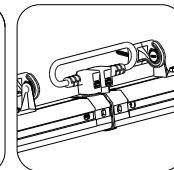

Connecting the accessory 3 (connection cable).

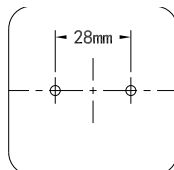

1 Accessory 7-2, 28mm distance between the 2 hole site of pothook ;

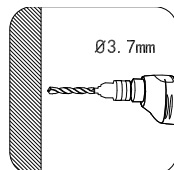

2 Properly drill out 3.7mm installation hole on the ceiling according to the design paper ;

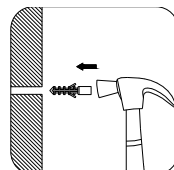

3 Nailing the accessories 7-1 (swelling plastic button) into the hole.

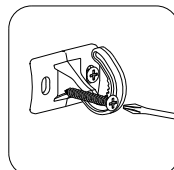

4 Use accessory 7-3 screw to firm the accessory 7-2 pothook ;

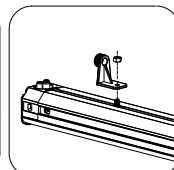

5 Properly adjust the sliding block at the correct position, use the accessory 7-4 nut to firm accessory 7-5 hook rail ;

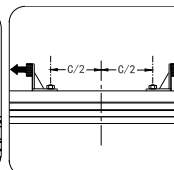

6 Installing another end hook rail, make sure installation in relative direction.