

# LED ABRASION RESISTANT TRACK LIGHT

## Description:

Our LED Abrasion Resistant Track Light is offered in black, brushed nickel or white finishes and can be used with various lamp options. This product has an open-back design for an neat, industrial look.

## Features:

- Input Power: 120V
- Bulb Options (Included): LED PAR20, LED PAR30, LED BR20, LED BR30 or LED BR40
- Available Finish Options: Black, brushed nickel or white
- Dimmable option available.
- Lighting controls option available.
- 350° horizontal rotation and 90° vertical tilt.
- CRI >90
- L70 Lifetime: >50,000 hours
- 7 Year Warranty
- Dimensions (L x W x H): 2.5" x 3" x 8.5"



## Dimensions:

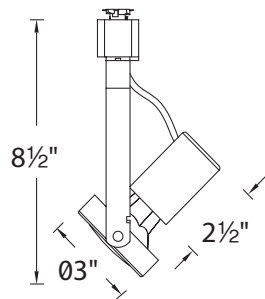

## COLOR OPTIONS



BLACK



BRUSHED  
NICKEL



WHITE

## Ordering Key:

ILWL763				
SERIES NUMBER	BULB OPTION	CCT	FINISH	ADDITIONAL OPTIONS
ILWL763	BR20	3 - 3000K	B - BLACK	DM - 0-10V DIMMING
	BR30	4 - 4000K	W - WHITE	
	BR40	5 - 5000K	BN - BRUSHED NICKEL	
	PAR20			
	PAR30			

SAMPLE ITEM NUMBER: IILWL763 BR40 3 B DM

